

WIRING INSTRUCTIONS

TITLE

PISTOL GRIP TOOLS

MILWAUKEE ELECTRIC TOOL CORP. 13135 WEST LISBON RD. BROOKFIELD, WIS.

DATE
Jan.'94

BULLETIN
58-01-0031

ROUTE WIRES
IN MAIN
TRAP FROM
BOTTOM TO
TOP AS
FOLLOWS: 8,
10, 11, 4 & 5.
WIRES MUST
NOT COVER
VENTS

ROUTE
JUMPER WIRE
#12 THROUGH
TRAP

ORIENTATE IN-LINE FASTON
TERMINALS AS SHOWN
(I.E. BARRELS TO THE
INSIDE), 4 PLACES.

ROUTE WIRE 9 UNDER
WIRES 10 & 11 AND
EXTEND BEYOND
MOTOR HOUSING
BEARING TRAP. THERE
CANNOT BE A BUILDUP
OF MORE THAN ONE
WIRE OVER THE
MOTOR HOUSING
BEARING TRAP.

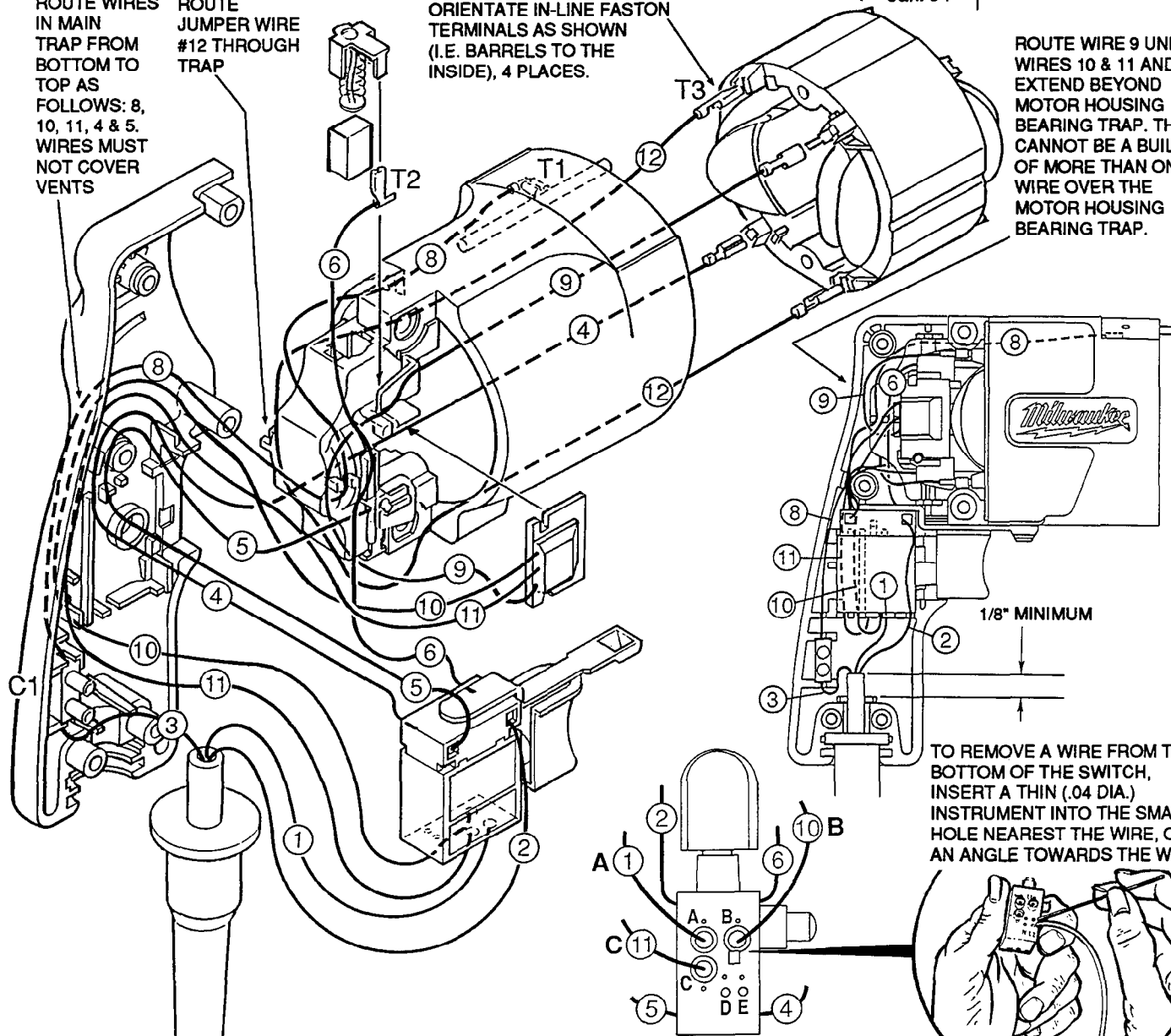

TO REMOVE A WIRE FROM THE
BOTTOM OF THE SWITCH,
INSERT A THIN (.04 DIA.)
INSTRUMENT INTO THE SMALL
HOLE NEAREST THE WIRE, ON
AN ANGLE TOWARDS THE WIRE.

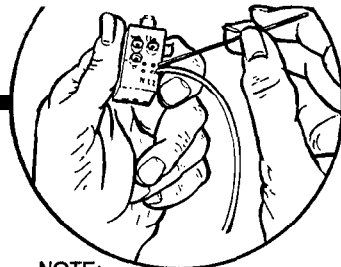

WIRING SPECIFICATIONS

| Wire No. | Wire Color | Origin or Part No. | Gauge | Length | Terminals, Connectors and End Wire Preparation |
|----------|------------|--------------------|-------|--------|------------------------------------------------|
| 1 | Black | Cord | 18 | 1-1/2" | Strip 5/16" and tin. |
| 2 | White | Cord | 18 | 2-3/4" | Strip 3/16" and tin. |
| ▲ 3 | Green | Cord | 18 | 1-1/2" | Strip 3/16" for C1. |
| 4 | Blue | 23-94-6270 | 18* | 3-1/8" | Strip 5/32" for T3 / Strip 3/16" and tin. |
| 5 | White | 23-94-6280 | 18* | 3-1/8" | Strip 3/16" for T2 / Strip 3/16" and tin. |
| 6 | Black | 23-94-6275 | 18* | 4-1/2" | Strip 3/16" for T2 / Strip 3/16" and tin. |
| ▲ 8 | Green | 23-94-6225 | 16* | 9-1/2" | Strip 3/16" for T1 / Strip 3/16" for C1. |
| 9 | Black | Module | 18* | 2-1/2" | Strip 5/32" for T3. |
| 10 | Black | Module | 18* | 6" | Strip 5/16" and tin. |
| 11 | Blue | Module | 18* | 6" | Strip 5/16" and tin. |
| 12 | Black | 23-94-6265 | 18* | 3-3/4" | Strip 5/32" for T3 on both ends. |

BULK LEAD WIRE - BULLETIN 58-01-0003

▲ FOR DOUBLE INSULATED, DISREGARD WIRES AND TERMINALS

NOTE:
All leads must be held to $\pm 1/8"$.
All lead lengths are before stripping.

TERMINAL DESCRIPTION

| Code | Part No. | Qty. |
|------|------------|------|
| ▲ T1 | 23-74-0605 | 1 |
| T2 | 23-74-0900 | 2 |
| T3 | 23-74-1060 | 4 |

CONNECTOR DESCRIPTION

| | | |
|------|------------|---|
| ▲ C1 | 22-56-0456 | 1 |
|------|------------|---|