

# WIRING INSTRUCTIONS

## TITLE

## PISTOL HANDLE TOOLS

MILWAUKEE ELECTRIC TOOL CORP.

13135 WEST LISBON RD. BROOKFIELD, WIS.

DATE  
Dec. '79

## BULLETIN

58-01-0647

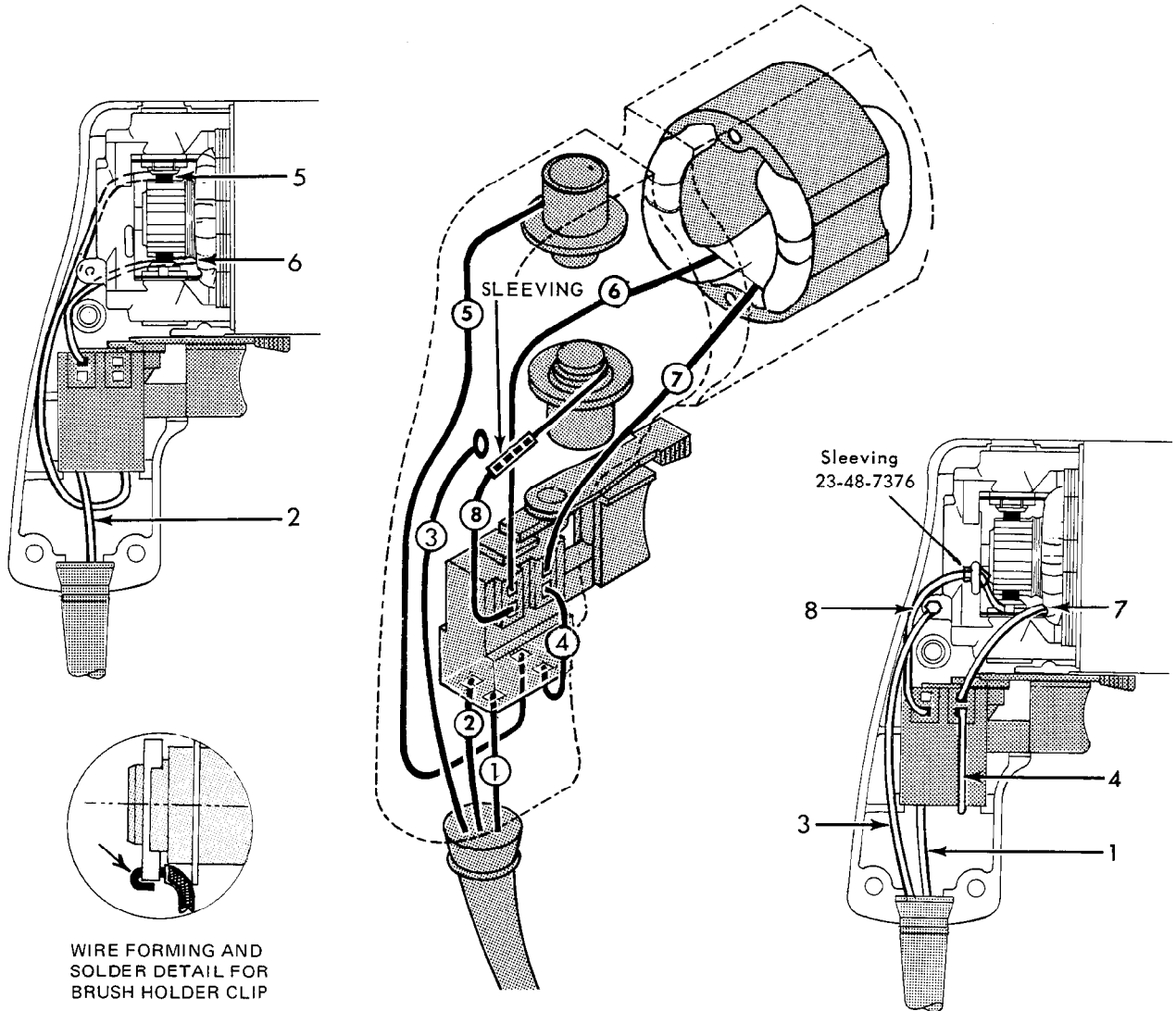

### WIRING SPECIFICATIONS

Wire No.	Wire Color	Origin or Gauge	Length	Terminals, Connectors and 1 or 2 End Wire Preparation.
1	White	Cord	1-3/4"	Strip 3/8" & tin
2	Black	Cord	1-3/4"	Strip 3/8" & tin
3	Green	Cord	4"	Strip 3/16" & use T1
4	Black	20	2-1/2"	Supplied with switch
5	White	Brush	7"	Strip 3/8" & tin /Strip 1/4" & solder
6	Blue	Field	3-3/4"	Strip 3/8" & tin
7	White	Field	3"	Strip 3/8" & tin
8	Blue	Brush	4-3/4"	Strip 3/8" & tin /Strip 1/4" & solder

#### NOTE:

All leads must be held to  $\pm 1/8"$ .  
All field leads to be measured from and perpendicular to laminations.  
All lead lengths are before stripping.

### TERMINAL DESCRIPTION

Code	Part No.	Qty.
T1	23-74-0390	1

### CONNECTOR DESCRIPTION

Code	Part No.	Qty.