

WIRING INSTRUCTIONS

TITLE

DOUBLE REDUCTION D-HANDLE TOOLS

MILWAUKEE ELECTRIC TOOL CORP. 13135 WEST LISBON RD. BROOKFIELD, WIS.

DATE
July'88

BULLETIN

58-01-0770

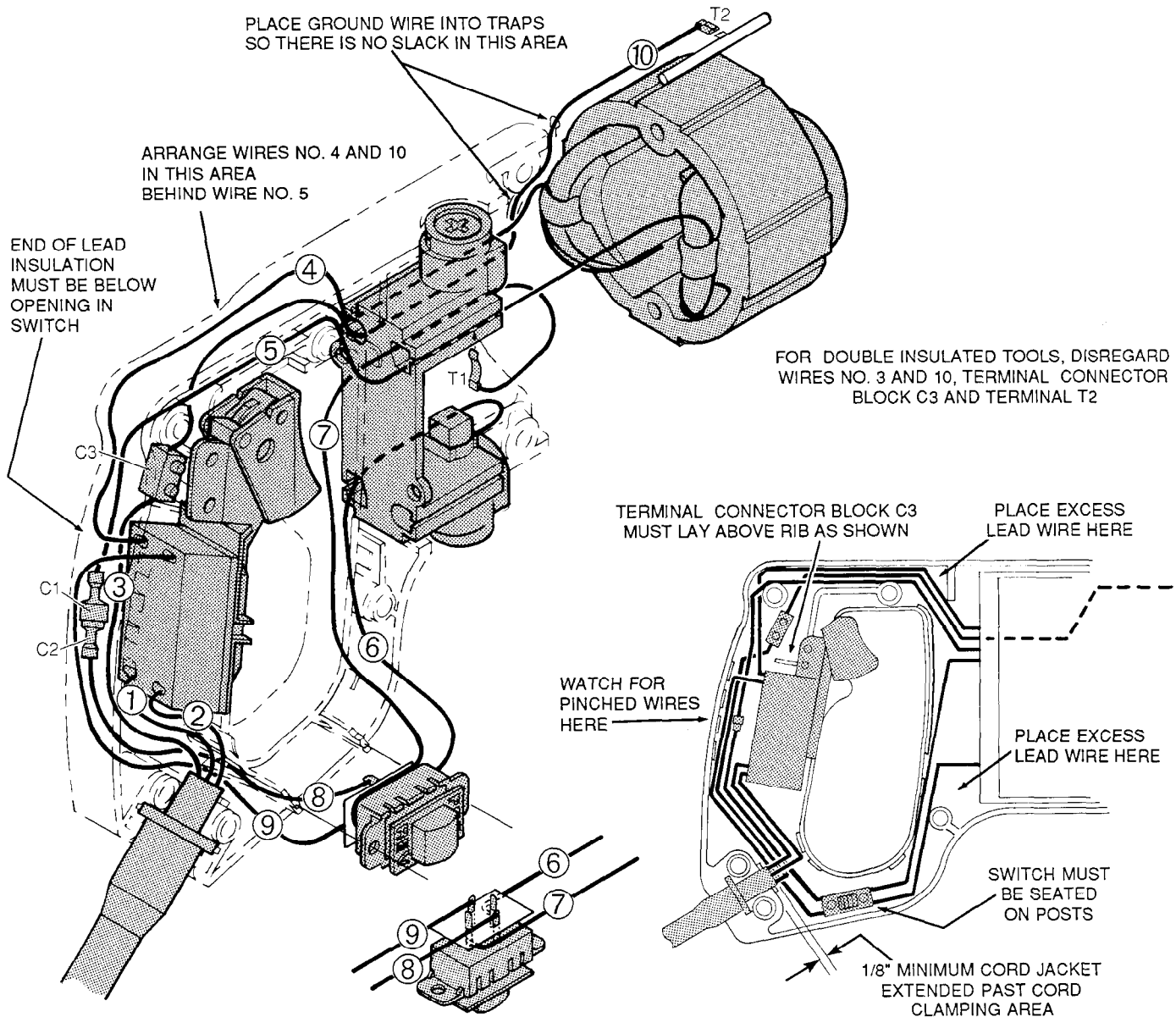

WIRING SPECIFICATIONS

Wire No.	Wire Color	Origin or Gauge	Length	Terminals, Connectors and 1 or 2 End Wire Preparation
1	Black	Cord	2-11/16"	Strip 3/8" and Tin
2	White	Cord	2-11/16"	Strip 3/8" and Tin
3	Green	Cord	4-1/2"	Strip 3/16" and Tin for C3
4	Red	Field	8-1/2"	Strip 3/8" and Tin
5	Brown	Field	8-1/2"	Strip 3/16" for C1
6	Black	18 Ga.*	5-1/4"	Strip 1/4" for T1
7	Black	18 Ga.*	7-1/4"	Strip 1/4" for T1
8	Black	18 Ga.*	3-1/8"	Strip 3/16" for C2
9	Black	18 Ga.*	5-1/4"	Strip 3/8" and Tin
10	Green	20 Ga.	8-3/4"	Strip 3/16" for T2 / Strip 3/16" and Tin for C3

* Component of Switch Assembly

NOTE:

All leads must be held to $\pm 1/8"$.
All field leads to be measured from
and perpendicular to laminations.
All lead lengths are before stripping.

TERMINAL DESCRIPTION

Code	Part No.	Qty.
T1	22-44-0090	2
T2	23-74-0615	1

CONNECTOR DESCRIPTION

C1	23-74-0440	1
C2	23-74-0430	1
C3	22-56-0456	1