



SERVICE PARTS LIST

BULLETIN NO.
54-00-2774

SPECIFY CATALOG NO. AND SERIAL NO. WHEN ORDERING PARTS		REVISED BULLETIN	DATE
M18™ Force Logic™ 10,000 PSI Hydraulic PUMP			Sept. 2024
CATALOG NO.	2774-20	SERIAL NO.	K15A&B
		WIRING INSTRUCTION	

SERVICE PARTS

PAGE 2

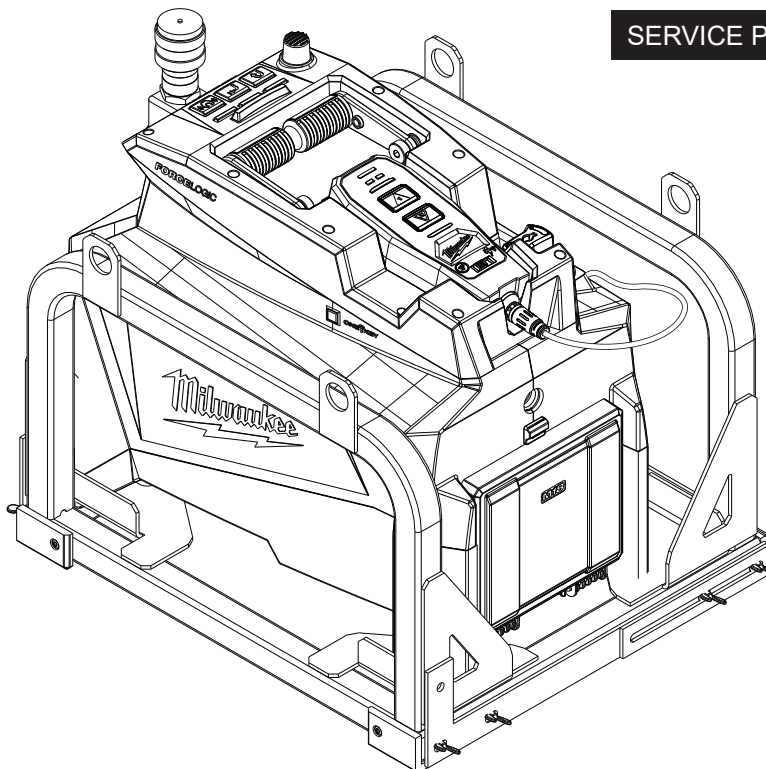

Only maintenance, service, repairs, and replacements of parts as defined in the Operator's Manual can be performed by the user.

All other repairs are to ONLY be performed by personnel authorized by MILWAUKEE TOOL. Do not attempt to install other parts; this COULD void your tool warranty.

For service, parts, or inquiries, contact us:

- Customer Service at 1.800.SAWDUST (1.800.729.3878)
- E-Service tool repair at: www.milwaukeetool.com/e-service
- Find a local authorized MILWAUKEE service location at Milwaukeetool.com
- Find a MILWAUKEE factory Service Center Location or MILWAUKEE factory Central Repair Center at Milwaukeetool.com. Send the following, posted paid and insured:
 - Your name, address, and phone number
 - Description of the issues
 - Copy of the proof of purchase
 - Tool, charger, and batteries involved with the issues

MILWAUKEE factory Central Repair Centers:

MILWAUKEE TOOL
Central Repair
1401 Sycamore Avenue
Greenwood, MS 38930

MILWAUKEE TOOL
Central Repair
2198 Southtech Drive
Greenwood, IN 46143

Removing/Replacing the Coupler (88):

WARNING! Follow the accessory manufacturers' installation instructions. Other uses may cause damage to the tool, accessories, and workpiece.

To remove the coupler:

1. Remove the battery pack.
2. Push and hold down the manual pressure release button for five seconds.
3. Place a wrench on the coupler swivel to steady swivel.
4. Place a second wrench on the coupler and loosen coupler.
5. Once removed, clean out any teflon tape still in the coupler area. **WARNING!** Only use couplers that are rated 10,000 psi (700 bar) or higher.

To replace the coupler:

1. Remove the battery pack.
2. Ensure the new coupler has teflon tape. If it does not, place two wraps of tape on the threads of the coupler. **NOTE:** Only use teflon tape.
3. Place a wrench on the coupler swivel to steady swivel.
4. Place the coupler onto the coupler swivel and, using a second wrench, tighten the coupler into place. **NOTE:** The coupler should be torqued to 45-55 lb.-ft.

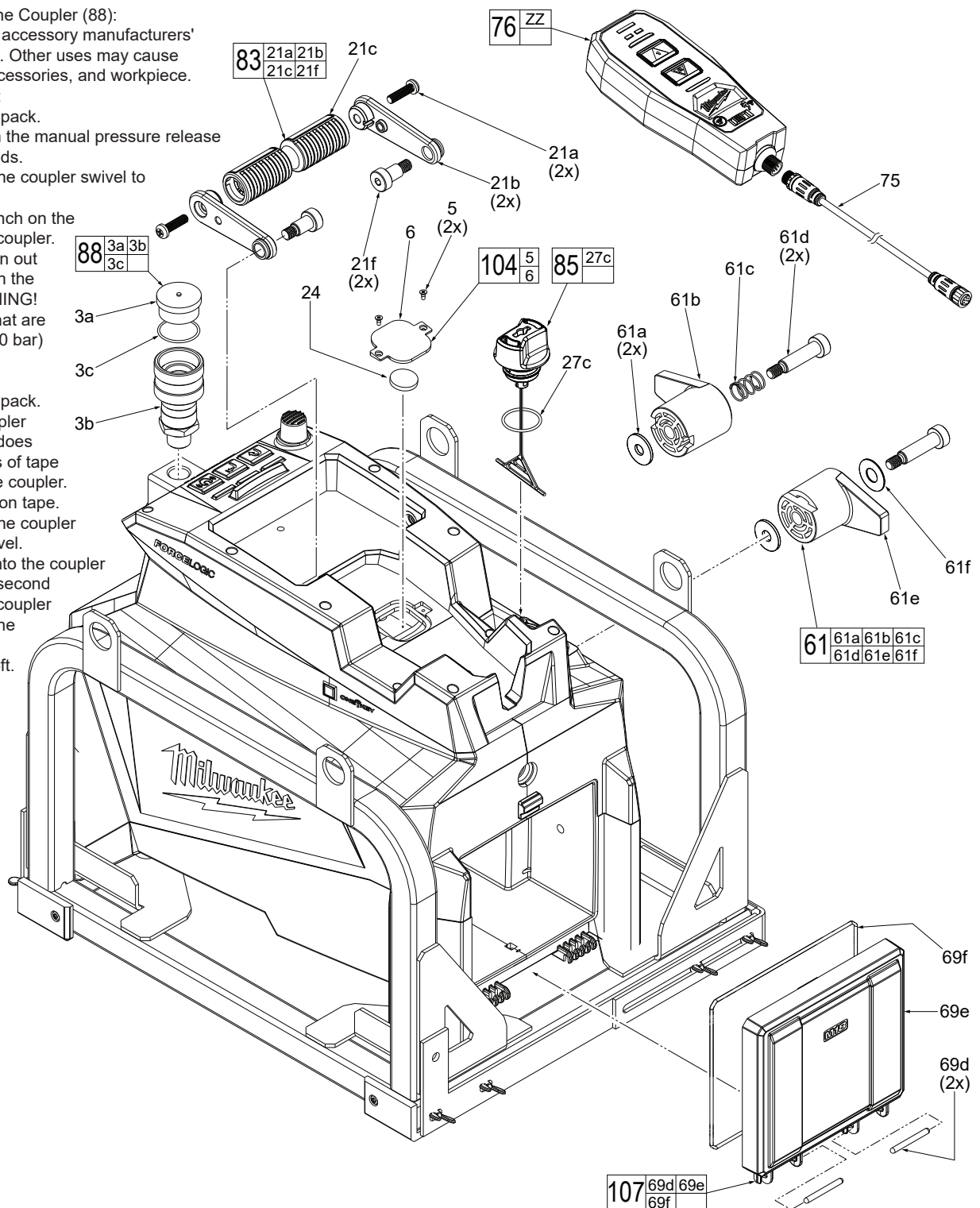

FIG.	PART NO.	DESCRIPTION OF PART	NO. REQ.
3a	-----	Coupler Plug	(1)
3b	-----	High Flow Coupler	(1)
3c	34-40-2774	O-Ring	(1)
5	05-81-1100	M2.6 x 6mm ST Phillips Screw	(2)
6	-----	Coin Cell Door with Anti-Static Seal	(1)
21a	-----	M6 x 22mm Pan Hd. Phillips Machine Screw	(2)
21b	-----	Bail Handle Support	(2)
21c	-----	Bail Handle Grip	(1)
21f	-----	Shoulder Bolt	(2)
24	-----	3V Coin Cell Battery (CR2032, available in stores)	(1)
27c	-----	O-Ring	(1)
61	43-72-0021	Cord Management Service Kit	(1)
61a	-----	Washer	(2)
61b	-----	Cord Wrap-Front	(1)
61c	-----	Spring	(1)
61d	-----	Shoulder Bolt	(2)

FIG.	PART NO.	DESCRIPTION OF PART	NO. REQ.
61e	-----	Cord Wrap-Rear	(1)
61f	-----	Washer	(1)
69d	-----	Door Pin	(2)
69e	-----	Battery Holder Door	(1)
69f	-----	Battery Door Seal	(1)
75	42-44-0024	Controller Cable	(1)
76	-----	Controller	(1)
76b	12-20-0204	Service Nameplate - Controller (Not Shown)	(1)
76c	10-20-2176	Warning Label - Controller (Not Shown)	(1)
78	12-20-0203	Service Nameplate - Pump (Not Shown)	(1)
79	10-20-2586	Remote Sequence Label-Pump (Not Shown)	(1)
83	43-62-0046	Top Handle Service Kit	(1)
85	42-52-0034	Oil Cap Service Assembly	(1)
88	42-90-0026	High Flow Coupler Service Kit with Plug	(1)
104	42-92-0064	Coin Cell Door Service Kit	(1)
107	42-92-0062	Battery Door Service Kit	(1)
ZZ	42-92-0069	Controller Battery Door Kit (Not Shown)	(1)