



SERVICE PARTS LIST

BULLETIN NO.
54-06-0021

SPECIFY CATALOG NO. AND SERIAL NO. WHEN ORDERING PARTS		REVISED BULLETIN	DATE
M18™ LED HP FLOOD LIGHT		54-06-0020	May 2018
CATALOG NO.	2360-20	STARTING SERIAL NO.	H02B
WIRING INSTRUCTION			

EXAMPLE:

00	0
----	---

 Component Parts (Small #)
 Are Included When Ordering
 The Assembly (Large #).

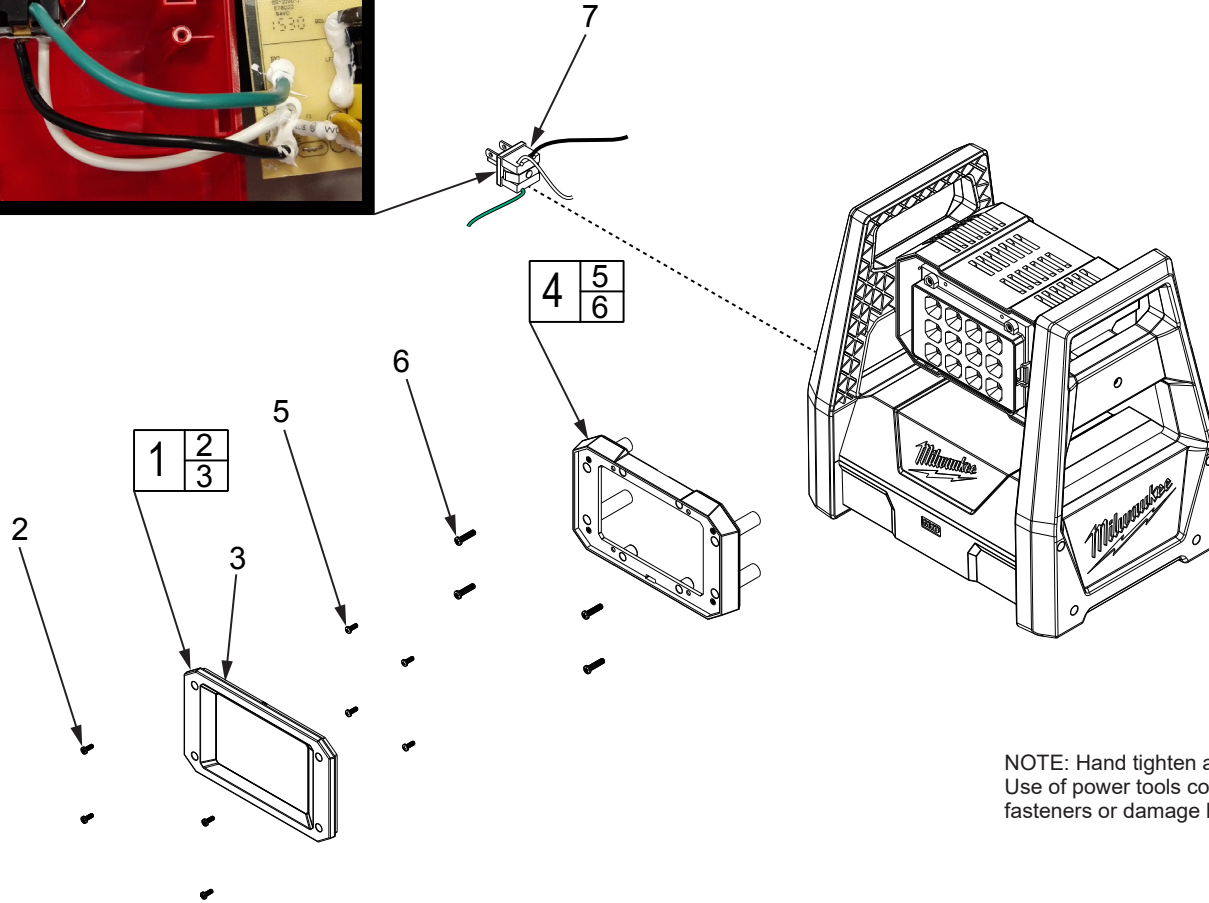
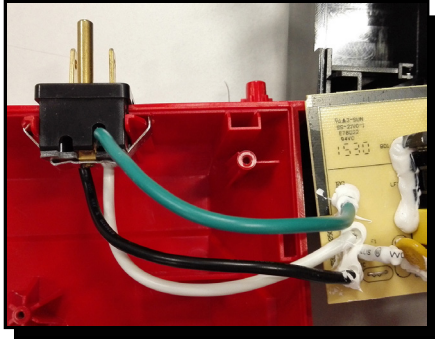

NOTE: Hand tighten all fasteners.
 Use of power tools could strip fasteners or damage housings.

FIG.	PART NO.	DESCRIPTION OF PART	NO. REQ.
1	44-06-0120	Lens Kit	(1)
2	-----	M3 x 8mm Pan Hd. T-10 Screw	(4)
3	-----	Lens w/ cover	(1)
4	43-76-0020	Lamp Housing Kit	(1)
5	-----	M3 x 8mm Pan Hd. Philips Machine Screw	(4)
6	-----	M4 x 16mm Pan Hd. T-20 Screw	(4)
7	23-36-0020	Plug w/ wires	(1)
8	12-20-2001	Service Nameplate (not shown)	(1)

FIG.	NOTES
7	When replacing the plug, wires must be carefully unsoldered from the circuit board. Replacement plug wires are to be soldered in the placement shown (see picture). Apply the solder from the back.
8	A clean, dry surface is essential for proper performance for any adhesive system. The area intended for application of any adhesive label or nameplate must be prepared by cleaning with isopropyl alcohol. The solvent is to be applied with a clean, lint free applicator and the surface allowed to dry before applying the label or nameplate.