



SERVICE PARTS LIST

BULLETIN NO.

54-07-3530

SPECIFY CATALOG NO. AND SERIAL NO. WHEN ORDERING PARTS		REVISED BULLETIN	DATE
M12™ 360° 3-PLANE LASER			Mar. 2024
CATALOG NO. 3632-20	SERIAL NO. L43A	WIRING INSTRUCTION	

Service needs pertaining to accuracy or calibration can only be performed at Milwaukee Authorized Repair Centers:

MILWAUKEE ELECTRIC TOOL Central Repair
1401 Sycamore Ave., Greenwood, MS 38930-7277

OR

Via e-Service at: www.milwaukeetool.com/e-service.

Questions, please call 1.800.SAWDUST

OR

Return it to a MILWAUKEE FACTORY SERVICE CENTER location, freight prepaid and insured. A copy of the proof of purchase should be included with the return product.

00 0

EXAMPLE:

Component Parts (Small #)
Are Included When Ordering
The Assembly (Large #).

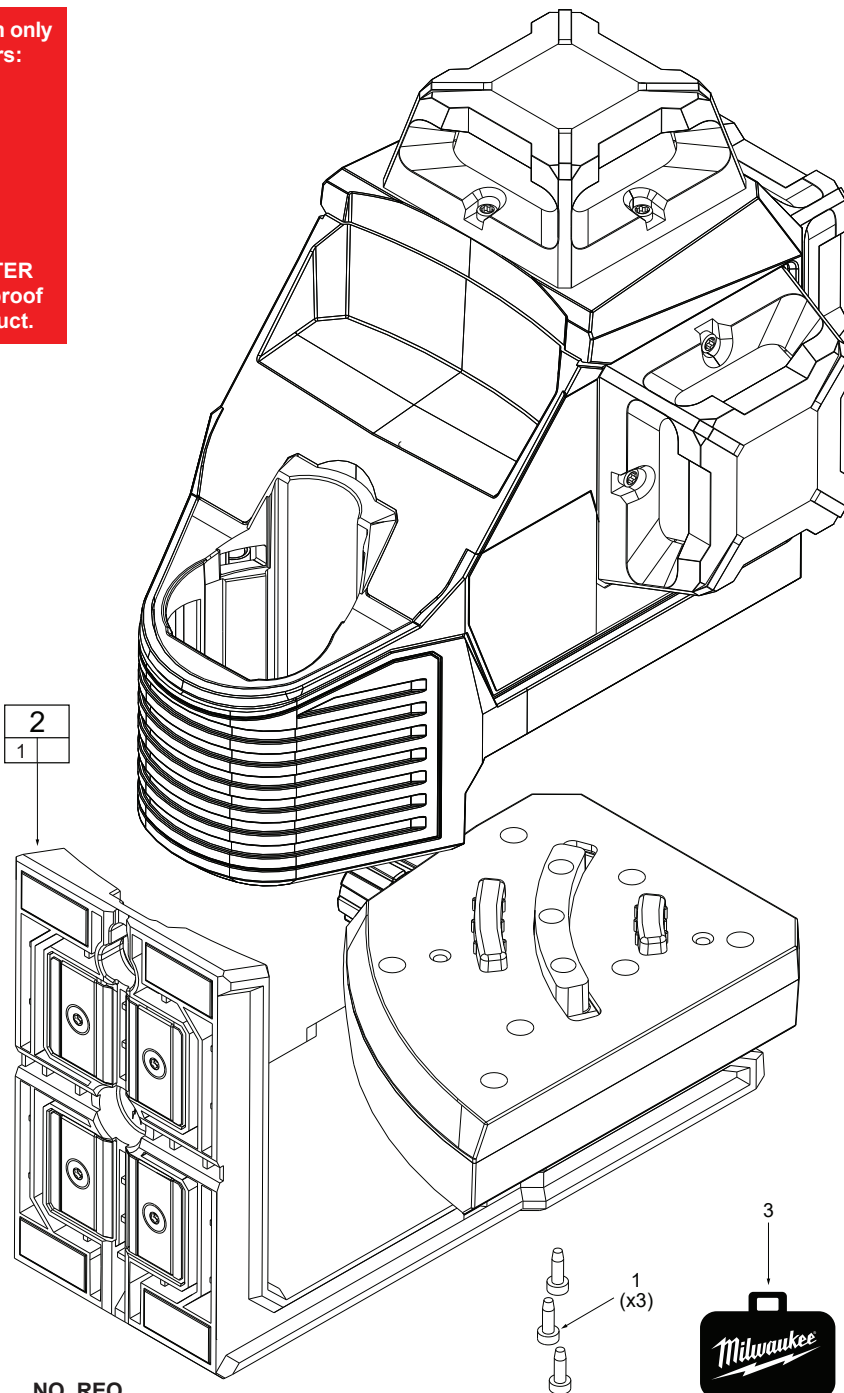

FIG.	PART NO.	DESCRIPTION OF PART	NO. REQ.
1	-----	M2.5 x 8mm Pan Hd. ST T8 Screw	(3)
2	31-10-0040	Mount Assembly	(1)
3	42-55-0208	BMC	(1)
4	12-20-3632	Service Nameplate (Not Shown)	(1)

FIG. NOTES

- 4 A clean, dry surface is essential for proper performance for any adhesive system. The area intended for application of any adhesive label or nameplate must be prepared by cleaning with isopropyl alcohol. The solvent is to be applied with a clean, lint free applicator and the surface allowed to dry before applying the label or name plate.

MILWAUKEE TOOL • www.milwaukeetool.com
13135 W. LISBON RD., BROOKFIELD, WI 53005

Drwg. 5