



SERVICE PARTS LIST

BULLETIN NO.
54-20-0045

SPECIFY CATALOG NO. AND SERIAL NO. WHEN ORDERING PARTS		REVISED BULLETIN	DATE
PAVER PAD KIT for MX FUEL Plate Compactor			May 2025
CATALOG NO. 49-49-2030	SERIAL NO.	WIRING INSTRUCTION	

EXAMPLE:

00	0
----	---

 Component Parts (Small #) Are Included
 When Ordering The Assembly (Large #).

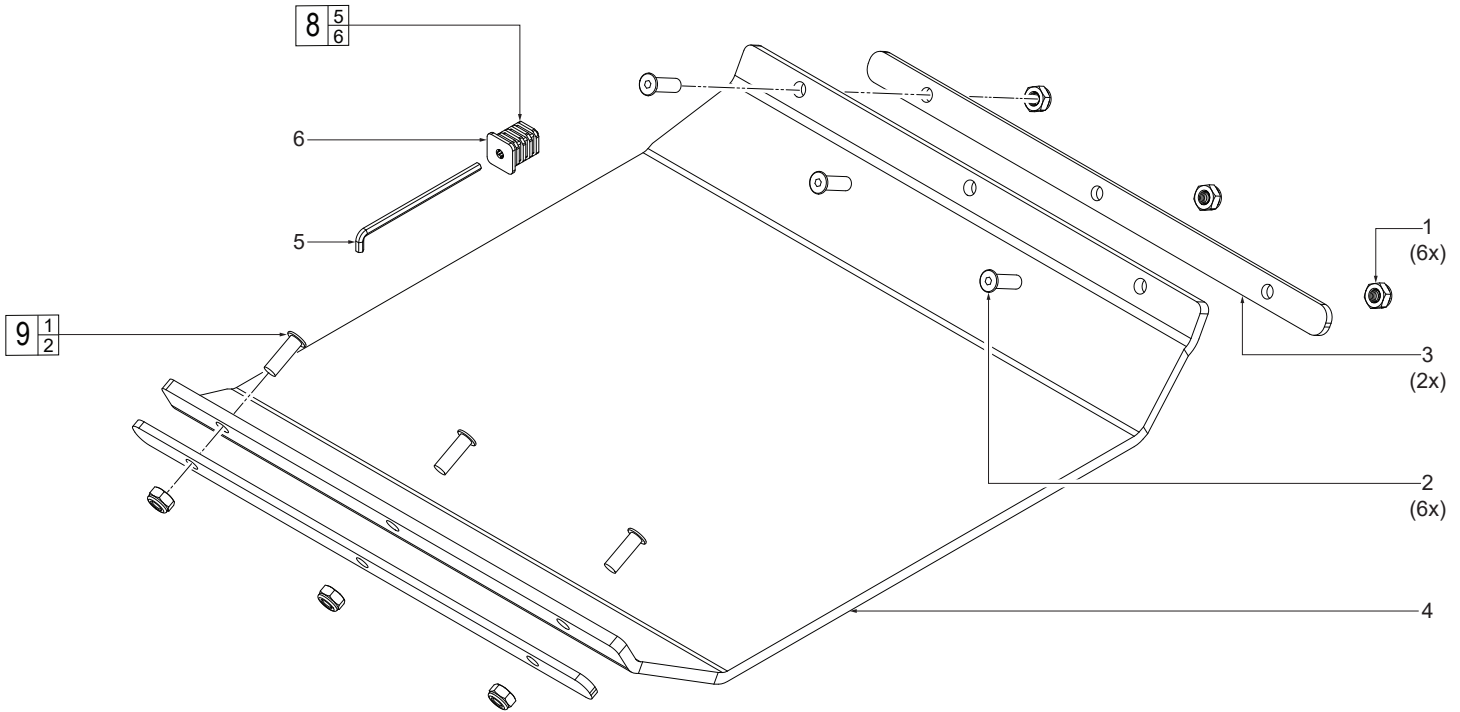

FIG.	PART NO.	DESCRIPTION OF PART	NO. REQ.
1	-----	M10-1.5 Lock Nut	(6)
2	-----	M10 x 1.5 Ultra-Low Head Skt. Screw	(6)
3	-----	Paver Pad Support	(2)
4	-----	Paver Pad	(1)
5	-----	Hex Key	(1)
6	-----	Hex Key Holder	(1)
8	14-46-9981	Hex Key Service Kit	(1)
9	14-46-9982	Paver Pad Hardware Service Kit	(1)

SCREW TORQUE SPECIFICATIONS

FIG.	PART NO.	DESCRIPTION OF FASTENER	WHERE USED	SEAT TORQUE	
				(lb-in)	(kgf-cm)
2	-----	M10 x 1.5 Ultra-Low Head Skt. Screw	Secure Paver Pad Support to Paver Pad	177±17	204±20