



SERVICE PARTS LIST

BULLETIN NO.
54-40-5460

SPECIFY CATALOG NO. AND SERIAL NO. WHEN ORDERING PARTS		REVISED BULLETIN	DATE
FOLDING MITER SAW STAND			May 2020
CATALOG NO. 48-08-0551	SERIAL NUMBER H93A	WIRING INSTRUCTION	

When installing a new Work Piece Support Feed Arm Assembly (14), the following items must be assembled onto Feed Arm (5b): Hex Socket Cap Screw (5a), End Bracket (7a), Feed Arm Sleeve (7c) with Round Plate (7r) and three Feed Arm Pads (5c).

NOTE:
Legs and other hardware are not shown for illustration clarity.

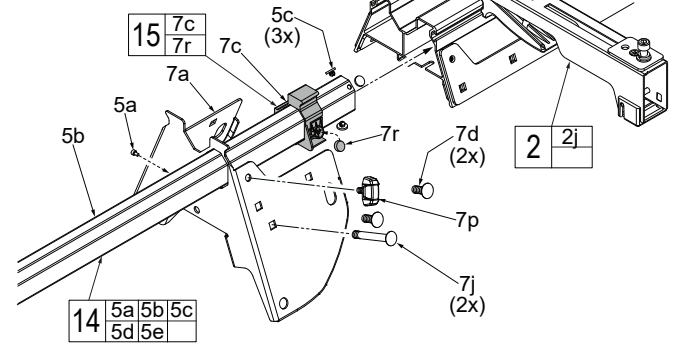

EXAMPLE:
Component Parts (Small #) Are Included When Ordering The Assembly (Large #).

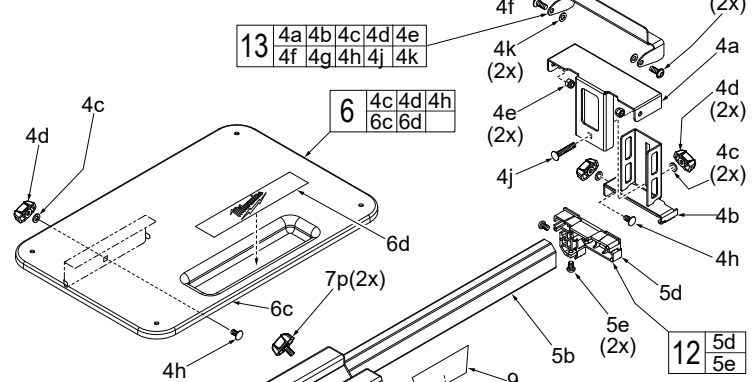

2j can be purchased at any hardware store.
Consisting of:
▪ M8 x 45mm Cap Screw w/ 6mm Socket Hex Drive
▪ M8 Lock Washer
▪ M8 Flat Washer

See detail below for exploded view of Main Body Assy. (7)

SEE PAGE 2 FOR PART LISTINGS

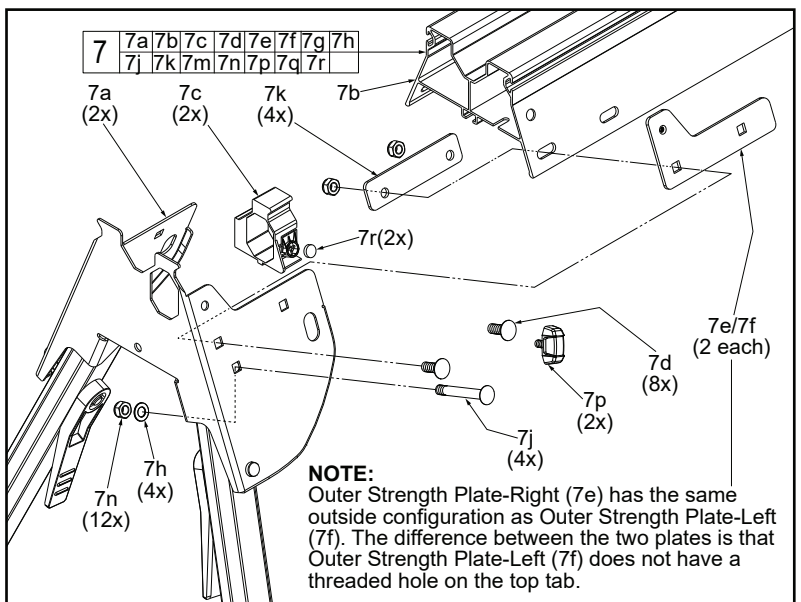
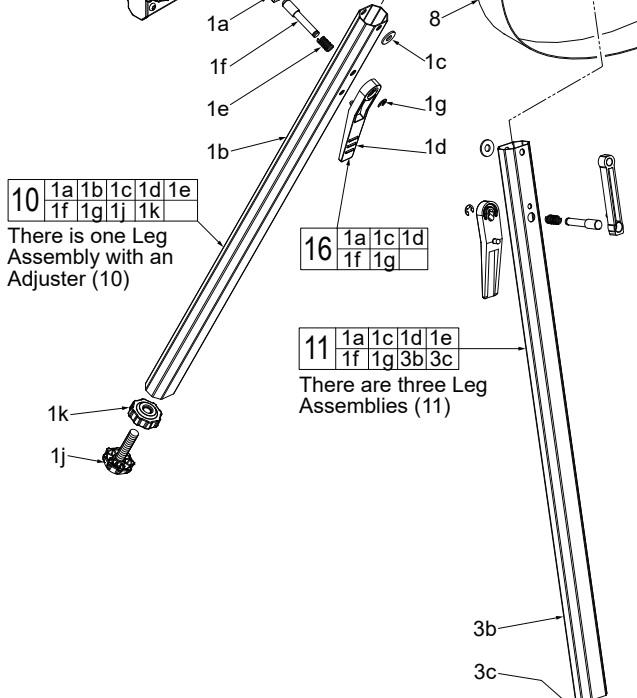

NOTE:
Outer Strength Plate-Right (7e) has the same outside configuration as Outer Strength Plate-Left (7f). The difference between the two plates is that Outer Strength Plate-Left (7f) does not have a threaded hole on the top tab.

NOTE: Fastener quantities shown here are for one end of the Main Body. For illustration clarity, only one corner (leg area) is depicted.

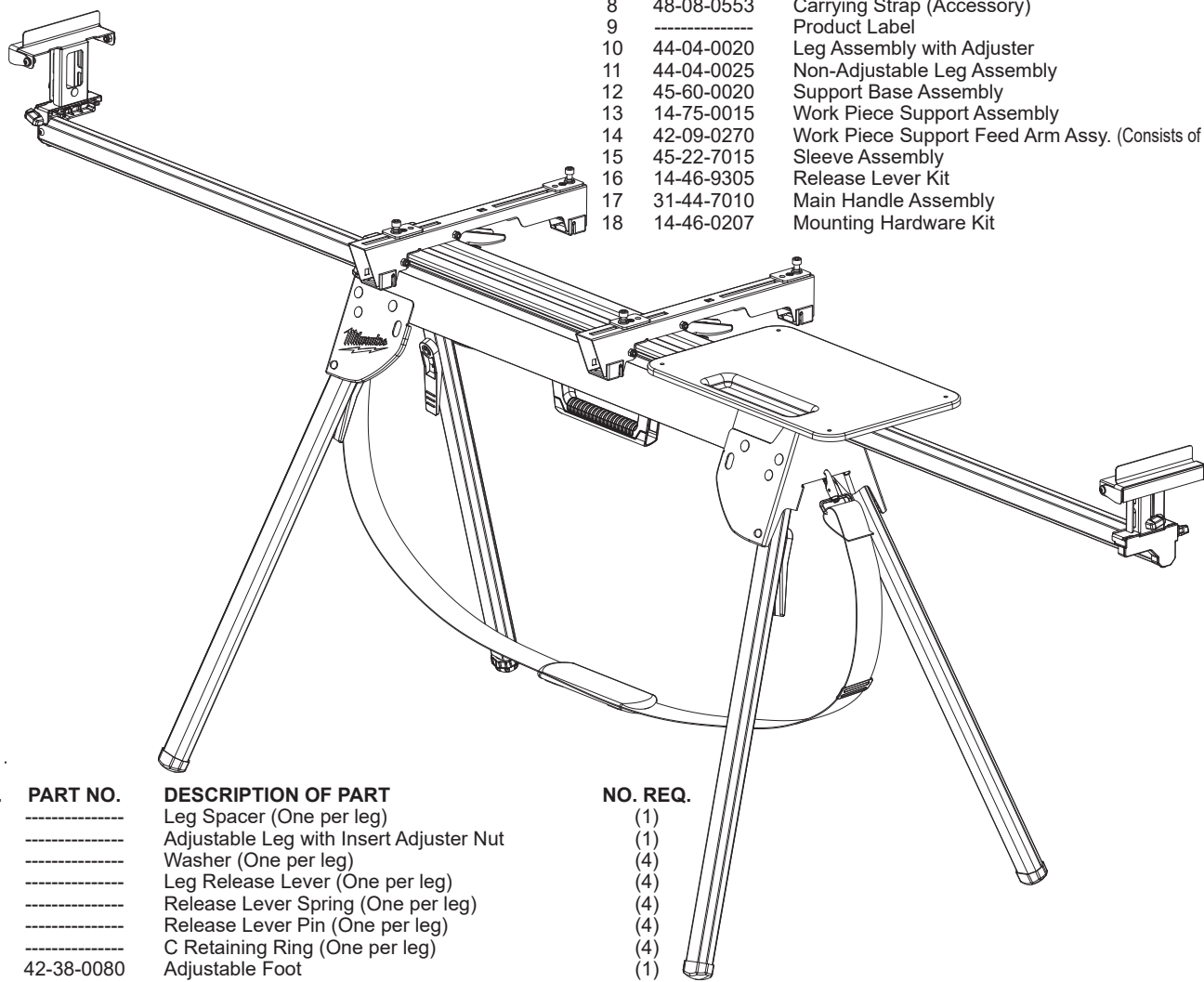

FIG.	PART NO.	DESCRIPTION OF PART	NO. REQ.
	7q -----	M8 Square Nut	(2)
	7r -----	Round Plate	(2)
	8 48-08-0553	Carrying Strap (Accessory)	(1)
	9 -----	Product Label	(1)
	10 44-04-0020	Leg Assembly with Adjuster	(1)
	11 44-04-0025	Non-Adjustable Leg Assembly	(3)
	12 45-60-0020	Support Base Assembly	(2)
	13 14-75-0015	Work Piece Support Assembly	(2)
	14 42-09-0270	Work Piece Support Feed Arm Assy. (Consists of 1 Assy.)	(2)
	15 45-22-7015	Sleeve Assembly	(2)
	16 14-46-9305	Release Lever Kit	(1)
	17 31-44-7010	Main Handle Assembly	(1)
	18 14-46-0207	Mounting Hardware Kit	(1)

FIG.	PART NO.	DESCRIPTION OF PART	NO. REQ.
1a	-----	Leg Spacer (One per leg)	(1)
1b	-----	Adjustable Leg with Insert Adjuster Nut	(1)
1c	-----	Washer (One per leg)	(4)
1d	-----	Leg Release Lever (One per leg)	(4)
1e	-----	Release Lever Spring (One per leg)	(4)
1f	-----	Release Lever Pin (One per leg)	(4)
1g	-----	C Retaining Ring (One per leg)	(4)
1j	42-38-0080	Adjustable Foot	(1)
1k	44-20-1215	Adjustable Foot Lock	(1)
2	48-08-0554	Mounting Bracket Assembly (Accessory, Set of 2)	(1)
2j	-----	Cap Screw, Lock Washer and Flat Washer (See Page One)	(2)
3b	-----	Non-Adjustable Leg (One per Assembly)	(3)
3c	42-38-0081	Fixed Foot (One per Assembly)	(3)
4a	-----	Work Piece Support Upper Bracket (One per Assy.)	(2)
4b	-----	Work Piece Support Lower Bracket (One per Assy.)	(2)
4c	-----	Washer (Two per Assembly)	(5)
4d	43-98-0800	Lock Knob (Two per Assembly)	(5)
4e	-----	M6 Hex Lock Nut (Two per Assembly)	(4)
4f	-----	Work Piece Support Top Plate (One per Assy.)	(2)
4g	-----	M6 x 16mm Screw with M4 Socket Hex Drive (2 per Assy.)	(2)
4h	-----	M6 x 9mm Step Bolt (One per Assembly)	(3)
4j	-----	M6 x 35mm Step Bolt (One per Assembly)	(2)
4k	-----	Washer (Two per Assembly)	(4)
5a	05-74-1080	M3 x 5mm Cap Screw w/ M2.5 Socket Hex Drive (1 per Assy.)	(2)
5b	-----	Feed Arm (One per Assembly)	(2)
5c	42-52-0030	Feed Arm Pad (Three per Assembly)	(6)
5d	-----	Work Piece Support Base (One per Assembly)	(2)
5e	-----	M6 x 10mm Pan Hd. T-30 Machine Screw (2 per Assy.)	(4)
6	48-08-0552	Work Table Assembly (Accessory)	(1)
6c	-----	Work Table	(1)
6d	-----	Logo Label	(1)
7	-----	Main Body Assembly	(1)
7a	-----	End Bracket	(2)
7b	-----	Main Body	(1)
7c	-----	Feed Arm Sleeve	(2)
7d	-----	M8 x 20mm Step Bolt	(8)
7e	-----	Outer Strength Plate-Right	(2)
7f	-----	Outer Strength Plate-Left	(2)
7g	-----	M8 x 12mm Pan Hd. Screw with 2mm Hex Drive	(2)
7h	-----	Washer	(4)
7j	-----	M8 x 61mm Step Bolt	(4)
7k	-----	Inner Strength Plate	(4)
7m	-----	Main Handle	(1)
7n	-----	M8 Hex Lock Nut	(12)
7p	43-98-0048	Lock Knob	(2)