

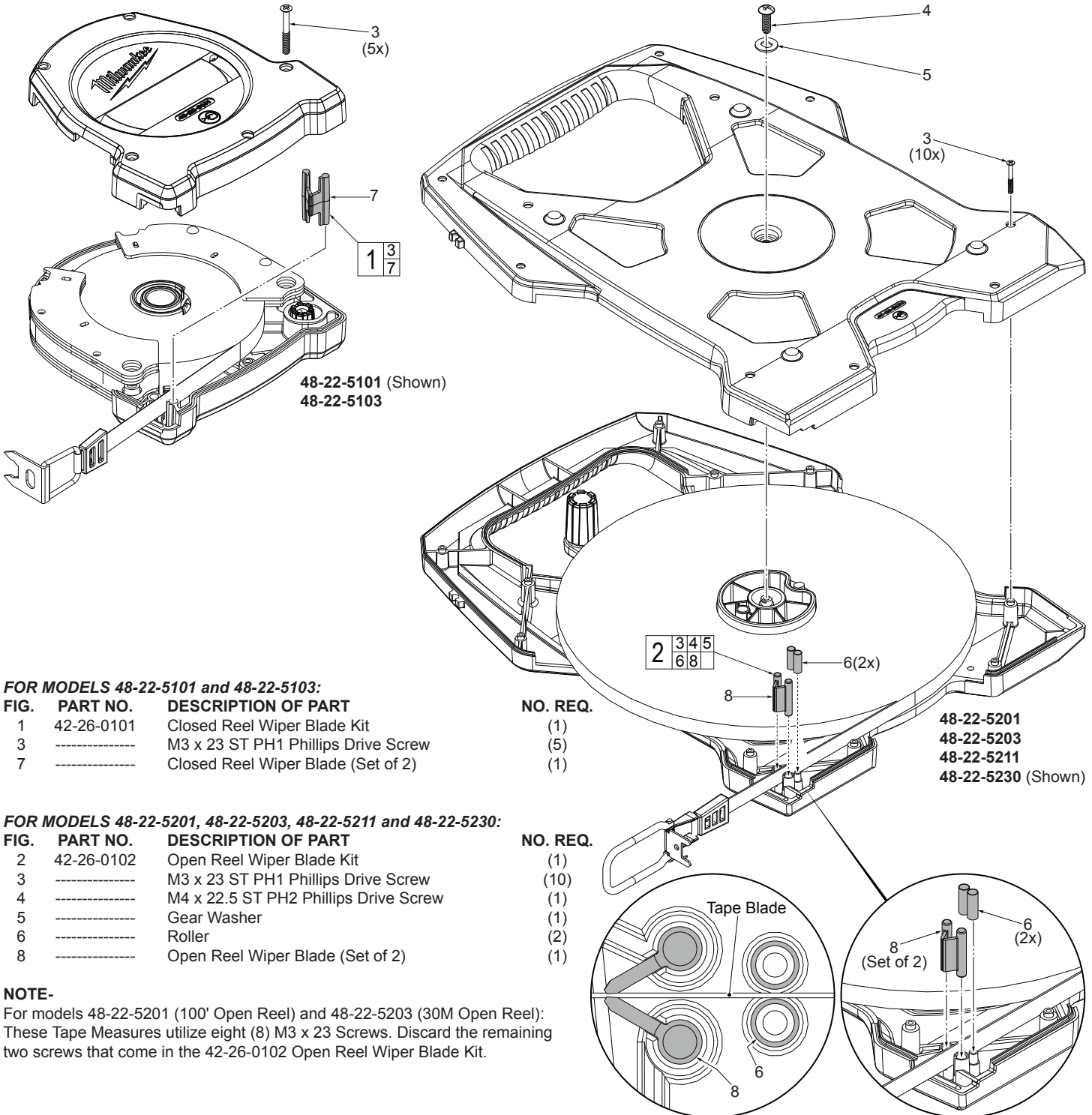

SERVICE PARTS LIST

BULLETIN NO.
54-49-0010

SPECIFY CATALOG NO. AND SERIAL NO. WHEN ORDERING PARTS		REVISED BULLETIN	DATE
LONG REEL TAPE MEASURES			Nov. 2016
CATALOG NO.	DESCRIPTION		
48-22-5101	100' Closed Tape Measure		
48-22-5103	30M Closed Tape Measure		
48-22-5201	100' Open Tape Measure		
48-22-5203	30M Open Tape Measure		
48-22-5211	100M Open Tape Measure		
48-22-5230	300' Open Tape Measure		



48-22-5101 (Shown)
48-22-5103

48-22-5201
48-22-5203
48-22-5211
48-22-5230 (Shown)

FOR MODELS 48-22-5101 and 48-22-5103:

FIG.	PART NO.	DESCRIPTION OF PART	NO. REQ.
1	42-26-0101	Closed Reel Wiper Blade Kit	(1)
3	-----	M3 x 23 ST PH1 Phillips Drive Screw	(5)
7	-----	Closed Reel Wiper Blade (Set of 2)	(1)

FOR MODELS 48-22-5201, 48-22-5203, 48-22-5211 and 48-22-5230:

FIG.	PART NO.	DESCRIPTION OF PART	NO. REQ.
2	42-26-0102	Open Reel Wiper Blade Kit	(1)
3	-----	M3 x 23 ST PH1 Phillips Drive Screw	(10)
4	-----	M4 x 22.5 ST PH2 Phillips Drive Screw	(1)
5	-----	Gear Washer	(1)
6	-----	Roller	(2)
8	-----	Open Reel Wiper Blade (Set of 2)	(1)

NOTE-
For models 48-22-5201 (100' Open Reel) and 48-22-5203 (30M Open Reel):
These Tape Measures utilize eight (8) M3 x 23 Screws. Discard the remaining
two screws that come in the 42-26-0102 Open Reel Wiper Blade Kit.