



## SERVICE PARTS LIST

BULLETIN NO.  
54-49-8401

SPECIFY CATALOG NO. AND SERIAL NO. WHEN ORDERING PARTS		REVISED BULLETIN	DATE
PACKOUT™ Tool Boxes			Oct. 2025
CATALOG NO.	48-22-8425	PACKOUT™ Large Tool Box	Page 1
	48-22-8424	PACKOUT™ Medium Tool Box	Page 2
	48-22-8450	PACKOUT™ Tool Box	Page 3
	48-22-8422	PACKOUT™ Compact Tool Box	Page 4
	48-22-8429	PACKOUT™ XL Tool Box	Page 5
	48-22-8423	PACKOUT™ XL Tool Box	Page 6

00 0

### EXAMPLE:

Component Parts (Small #) Are Included  
When Ordering The Assembly (Large #).

### 48-22-8425 PACKOUT™ (Large) Tool Box

FIG.	PART NO.	DESCRIPTION OF PART
1	43-62-8425	Top Handle Service Kit
2	-----	Pin
3	43-62-8424	Side Handle Service Kit
4	-----	Pin
5	44-20-8400	Latch Service Assembly (Set of 2)
6	31-01-8400	Storage Tray
7	43-44-8400	Lid Gasket (Not Shown)

### NO. REQ.

(1)  
(2)  
(1)  
(2)  
(1)  
(1)  
(1)

Latch Assembly

Locking Tabs

As an aid to removing a damaged Latch Assembly, use two large flat blade screwdrivers. Push blades between parts as shown. Twist both screwdrivers at same time to force the blades into opening and work the latch assembly over the two locking tabs.

To install a new latch assembly, position entire latch assembly over locking tabs with the two top lugs partially inserted in 'catch cavity' of main housing. Engage latch bar onto lid and gently press latch lever to slide assembly over two locking tabs and into place.

This removal and installation process will be the same where other service latches are offered in this system.

Pins to be  
installed from  
the inside of  
the handle.

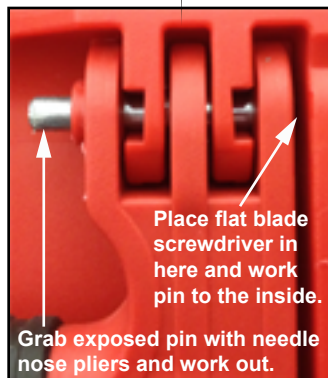
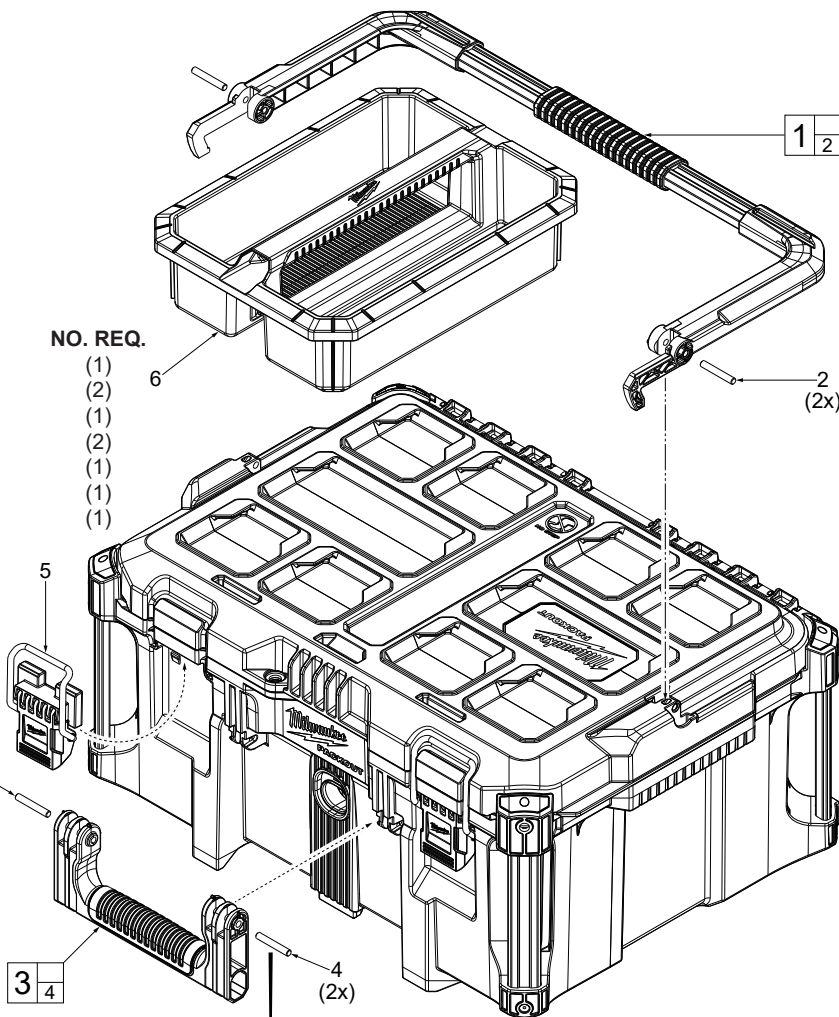

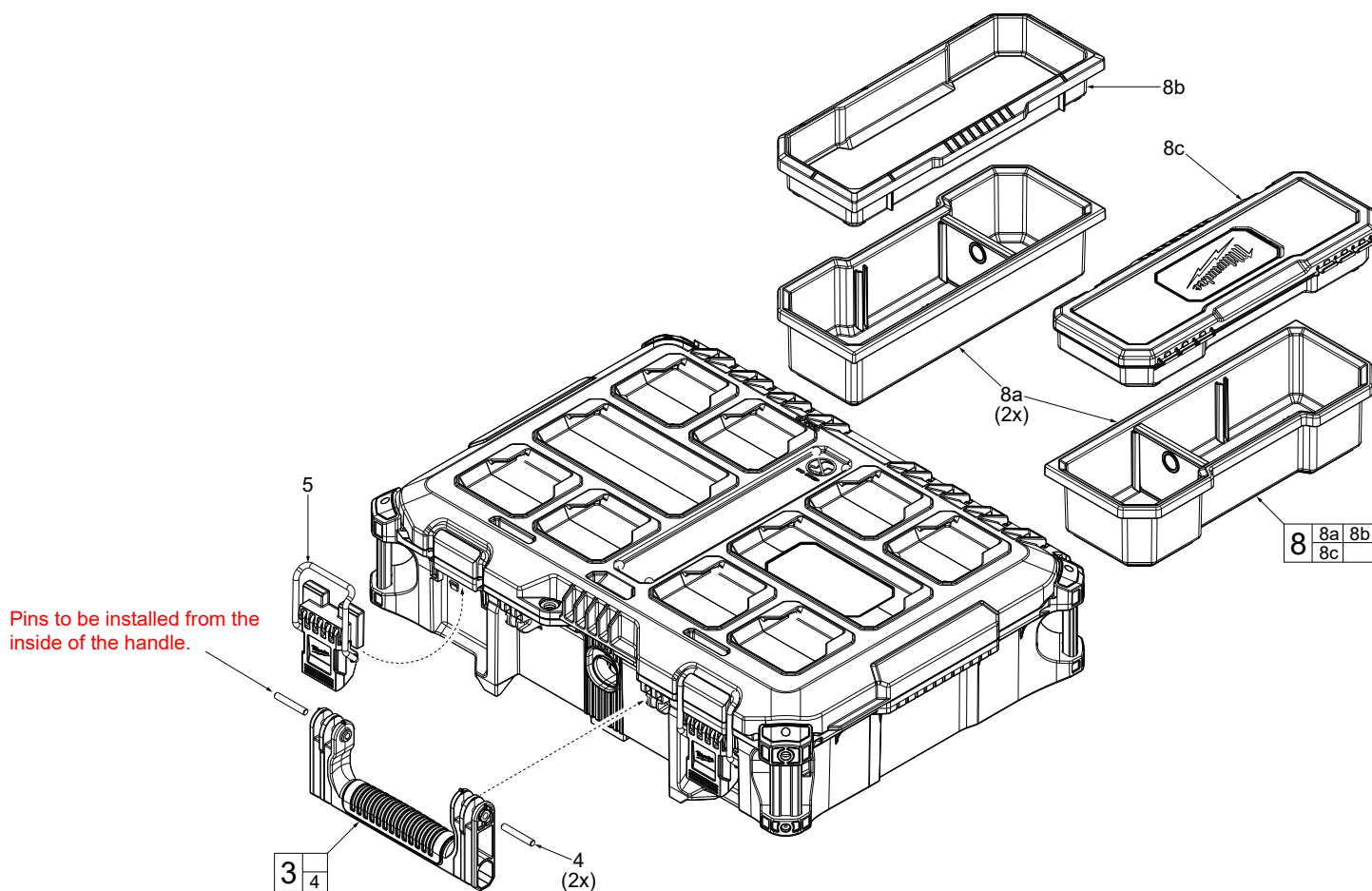

#### 48-22-8424 PACKOUT™ (Medium) Tool Box

FIG.	PART NO.	DESCRIPTION OF PART	NO. REQ.
3	43-62-8424	Side Handle Service Kit	(1)
4	-----	Pin	(2)
5	44-20-8400	Latch Service Assembly (Set of 2)	(1)
7	43-44-8400	Lid Gasket (Not Shown)	(1)
8	31-01-8424	Storage Bin Kit (Set of 4)	(1)
8a	-----	Deep Bin with Two Dividers	(2)
8b	-----	Shallow Bin	(1)
8c	-----	Shallow Bin with Cover	(1)

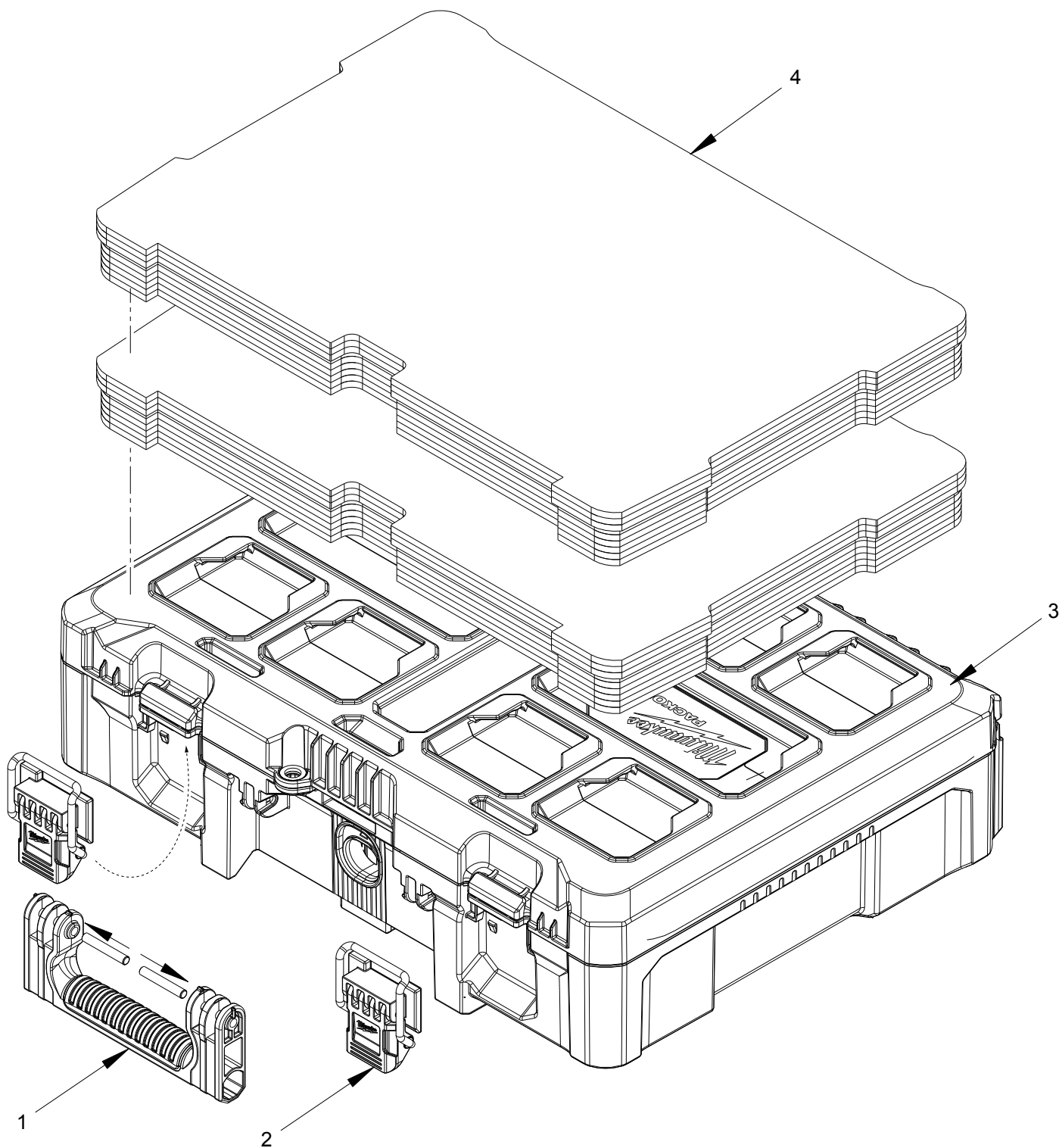

#### 48-22-8450 PACKOUT™ Tool Box Kit with Foam Dividers

FIG.	PART NO.	DESCRIPTION OF PART	NO. REQ.
1	43-62-8450	Kit Box Mono Block Handle with 2 Pins	(1)
2	44-20-8430	Latch Service Assembly (Set of 2)	(2)
3	43-44-8400	Lid Gasket (Not Shown)	(1)
4	48-22-8451	Foam Insert for PACKOUT™ Kit Box (Set of 2)	(1)

Note: Tray, Dividers and Gasket illustrated outside of PACKOUT, is to be assembled on the inside.

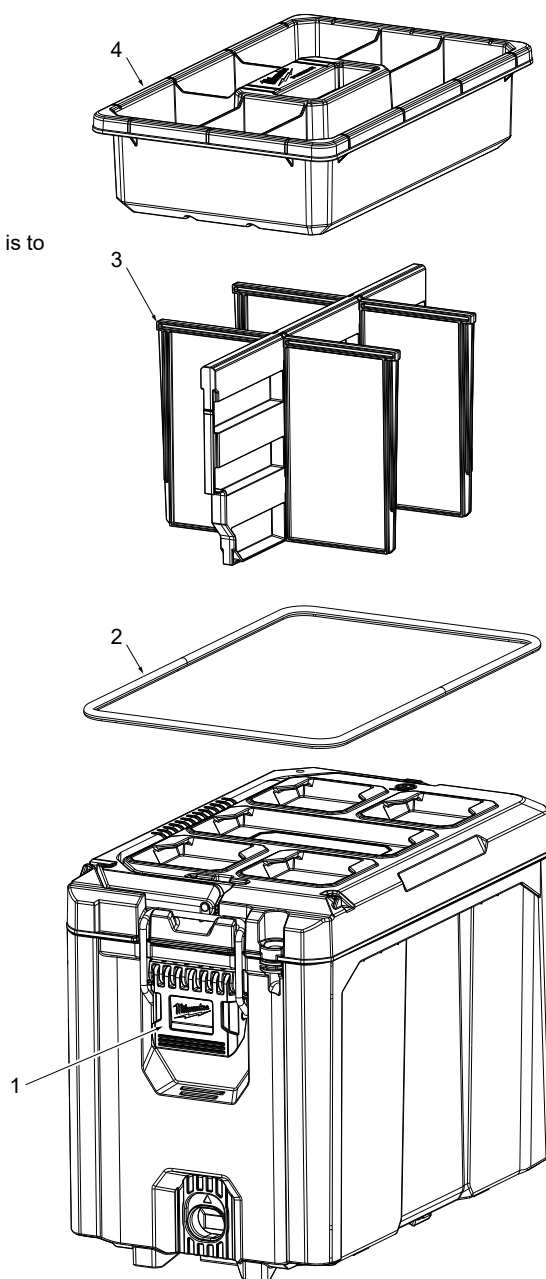

#### 48-22-8422 PACKOUT™ Compact Toolbox

FIG.	PART NO.	DESCRIPTION OF PART	NO. REQ.
1	44-20-8422	Latch Assembly	(1)
2	43-44-8422	Gasket	(1)
3	31-01-8423	Dividers	(1)
4	31-01-8422	Tray	(1)

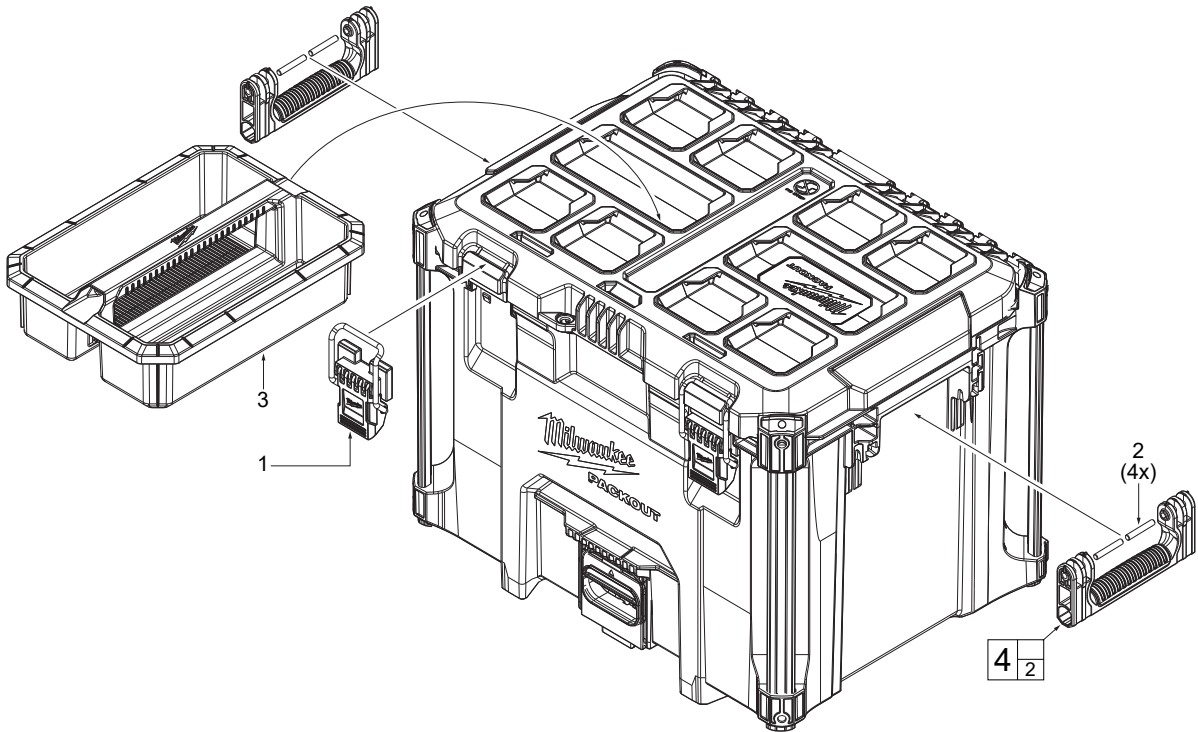

# **48-22-8429 PACKOUT™ XL Tool Box**

FIG.	PART NO.	DESCRIPTION OF PART	NO. REQ.
1	44-20-8400	Latch Service Assembly (Set of 2)	(1)
2	-----	Pin	(4)
3	31-01-8400	Service Tray	(1)
4	43-62-8426	Service Side Handle (Set of 1)	(2)
5	43-44-8400	Lid Service Gasket (Not Shown)	(1)

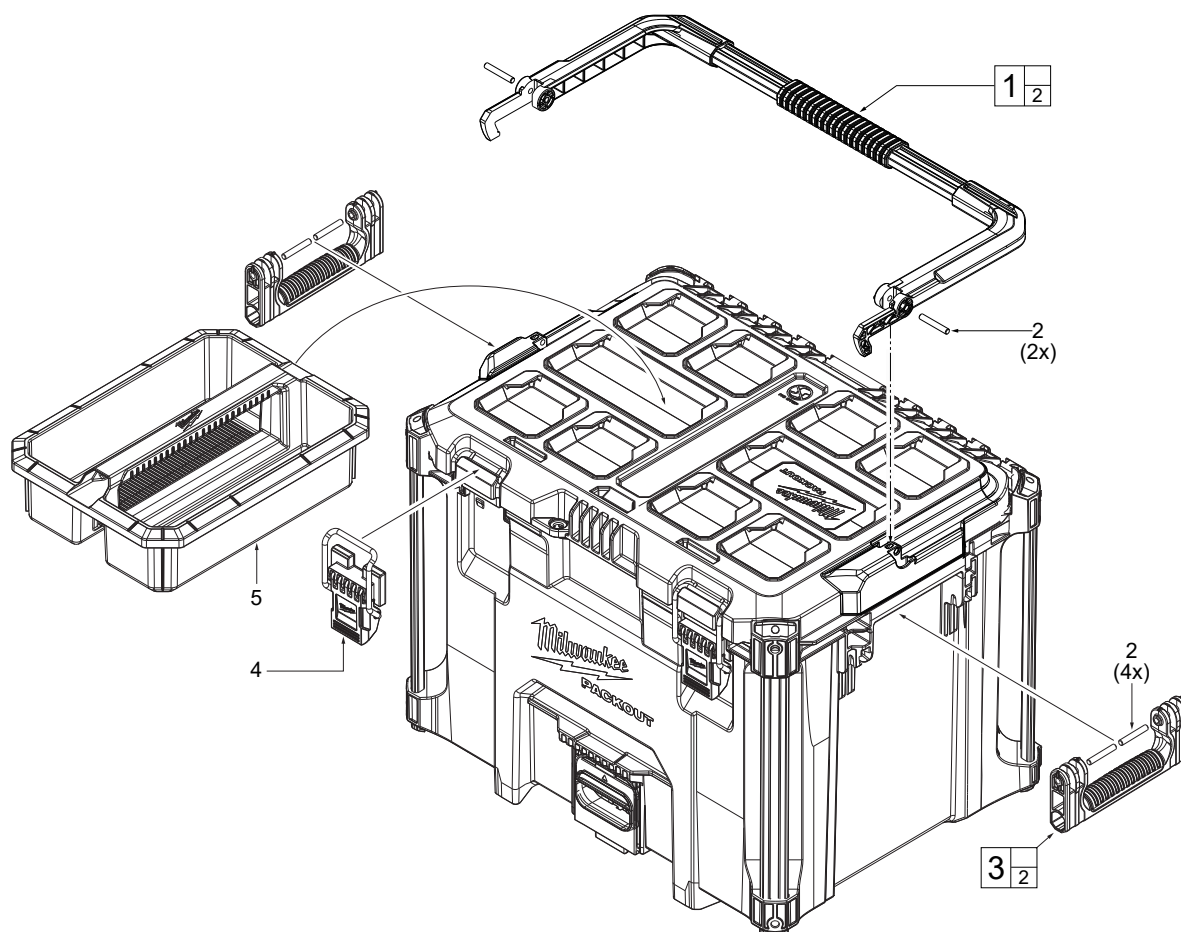

# **48-22-8423 PACKOUT™ XL Tool Box**

FIG.	PART NO.	DESCRIPTION OF PART	NO. REQ.
1	43-62-8425	Top Handle Service Kit	(1)
2	-----	Pin	(6)
3	43-62-8424	Service Side Handle Kit (Set of 1)	(2)
4	44-20-8400	Latch Service Assembly (Set of 2)	(1)
5	31-01-8400	Service Tray	(1)
6	43-44-8400	Lid Service Gasket (Not Shown)	(1)