



## SERVICE PARTS LIST

**BULLETIN NUMBER**  
**54-49-8402**

SPECIFY CATALOG NO. AND SERIAL NO. WHEN ORDERING PARTS		REVISED BULLETIN	DATE
PACKOUT™ Organizers			Apr. 2025
CATALOG NO.	SERIAL NO.	WIRING INSTRUCTION	

48-22-8430	PACKOUT™ Organizer Assembly	Page 1
48-22-8435	PACKOUT™ Compact Organizer Assembly	Page 2
48-22-8431	PACKOUT™ S-Organizer Assembly	Page 3
48-22-8436	PACKOUT™ S-Organizer Compact Assembly	Page 4
48-22-8432	PACKOUT™ Deep Organizer	Page 5
48-22-8433	PACKOUT™ Tilt Bin Organizer	Page 6

**EXAMPLE:**  
Component Parts (Small #) Are Included  
When Ordering The Assembly (Large #).

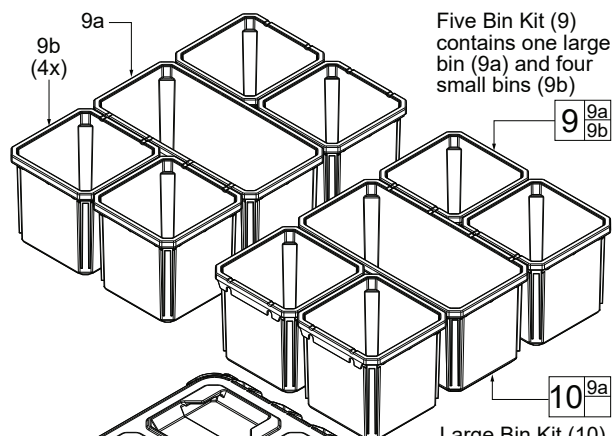

### 48-22-8430 PACKOUT™ Organizer

FIG.	PART NO.	DESCRIPTION OF PART	NO. REQ.
3	43-62-8430	Side Handle Service Kit	(1)
4	-----	Pin	(2)
5	44-20-8430	Latch Service Assembly (Set of 2)	(1)
7	43-44-8430	Lid Gasket (Not Shown)	(1)
9	31-01-0501	5 Bin Kit (Set of 1)	(2)
9a	-----	Large Bin	(1)
9b	-----	Small Bin	(4)
10	31-01-8430	Large Bin Kit (Set of 2)	(1)

Pins must be installed from  
the inside of the handle.

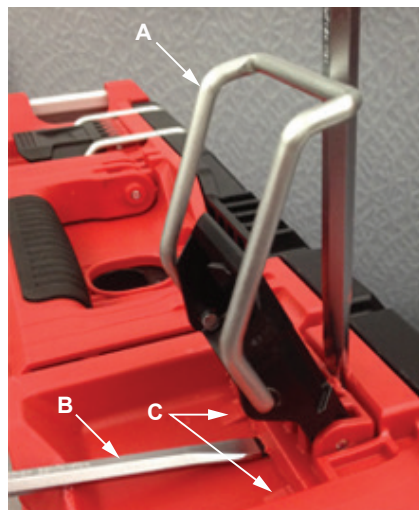

#### To Remove a Damaged Latch Assembly:

1. Push the blades of two large flat-blade screwdrivers (B) between the parts as shown.
2. Twist both screwdrivers at the same time to force the blades into opening and work the latch assembly (A) over the two locking tabs (C).

#### To Install a New Latch Assembly:

1. Put the latch assembly (A) on the locking tabs (C) with the two top lugs not fully engaged in the 'catch cavity' of main housing.
2. Engage the latch bar onto the lid and carefully push the latch lever to slide the assembly over the two locking tabs (C) and into position.

**NOTICE:** This removal and installation process is the same with other service latches offered in this system.

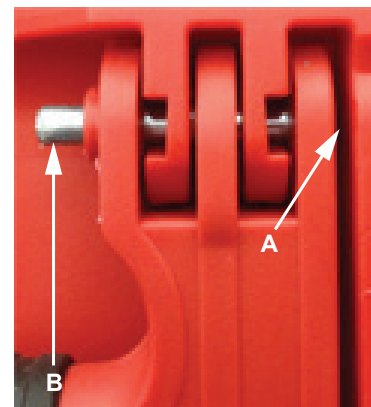

#### To Remove the Handle Pin:

1. Put a flat-blade screwdriver between the handle and the casing (A) and push the pin to the inside.
2. Use a needle-nose pliers to grab and pull the pin (B) out.

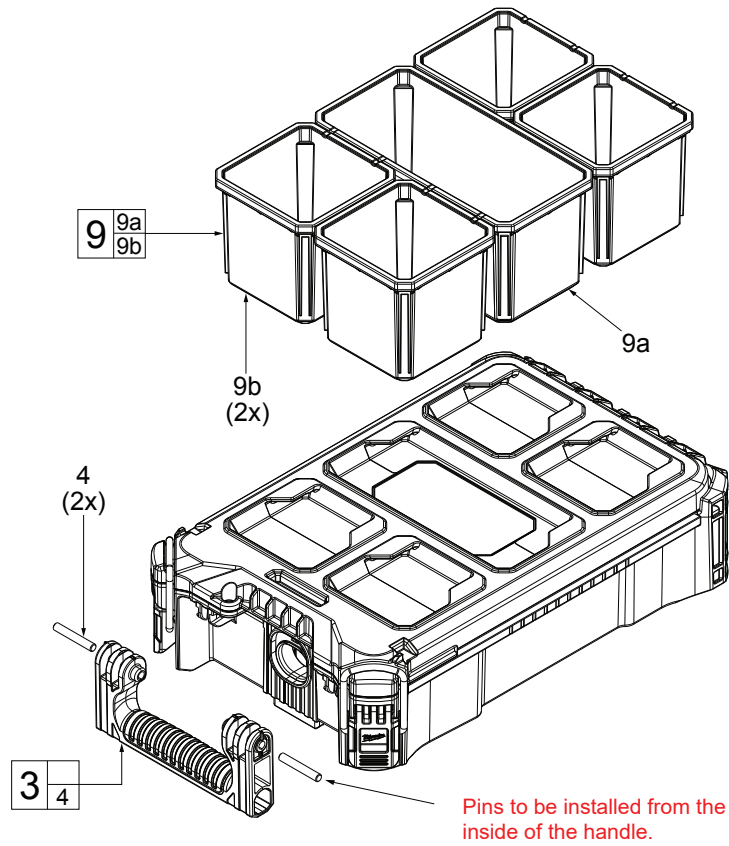

#### 48-22-8435 PACKOUT™ Compact Organizer

FIG.	PART NO.	DESCRIPTION OF PART	NO. REQ.
3	43-62-8435	Side Handle Service Kit	(1)
4	-----	Pin	(2)
7	43-44-8435	Lid Gasket (Not Shown)	(1)
9	31-01-0501	5 Bin Kit	(1)
9a	-----	Large Bin	(1)
9b	-----	Small Bin	(4)

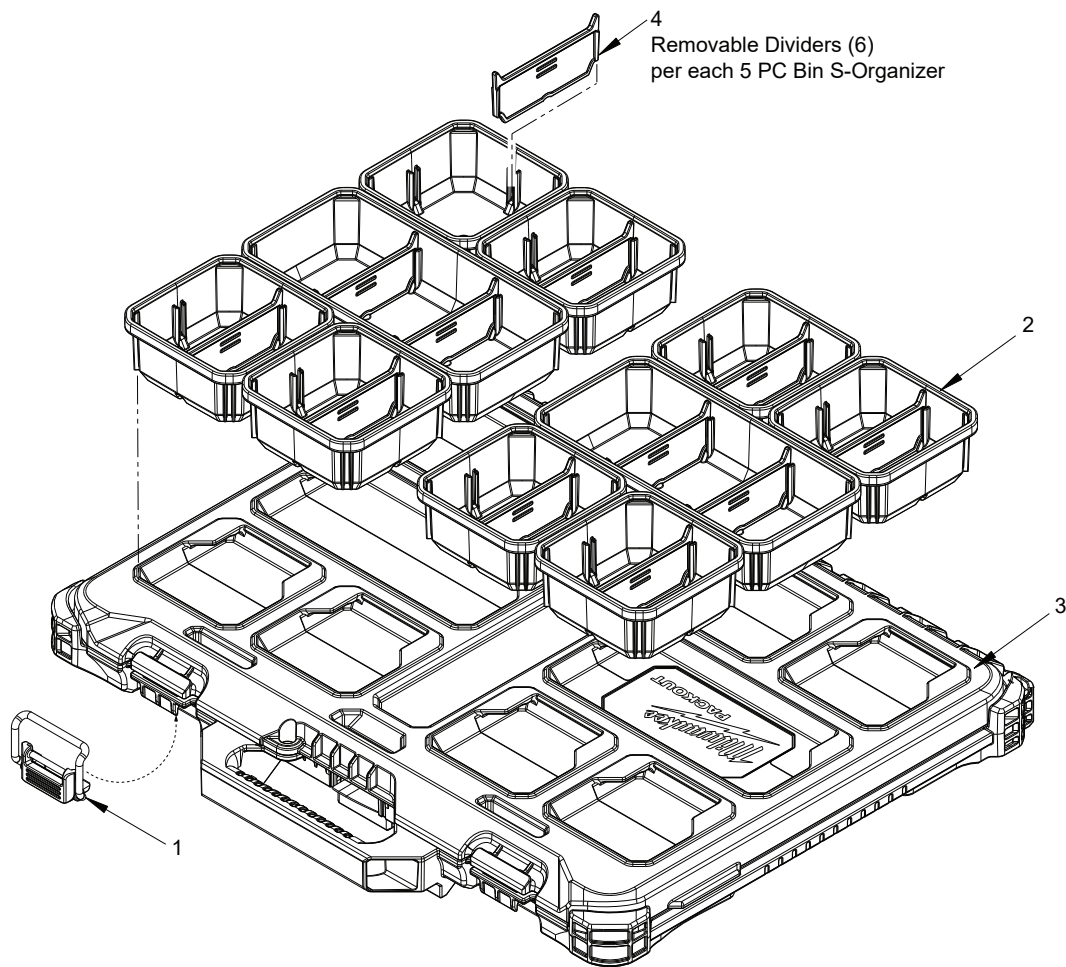

#### 48-22-8431 PACKOUT™ S-Organizer Assembly

FIG.	PART NO.	DESCRIPTION OF PART	NO. REQ.
1	44-20-8431	LP Organizer Latch (Set of 2)	(1)
2	31-01-0502	5 PC Bin S-Organizer with 6 Dividers	(2)
3	43-44-8430	Lid Gasket (Not Shown)	(1)
4	31-01-0503	Spare Divider Kit, 6 pcs.	(1)

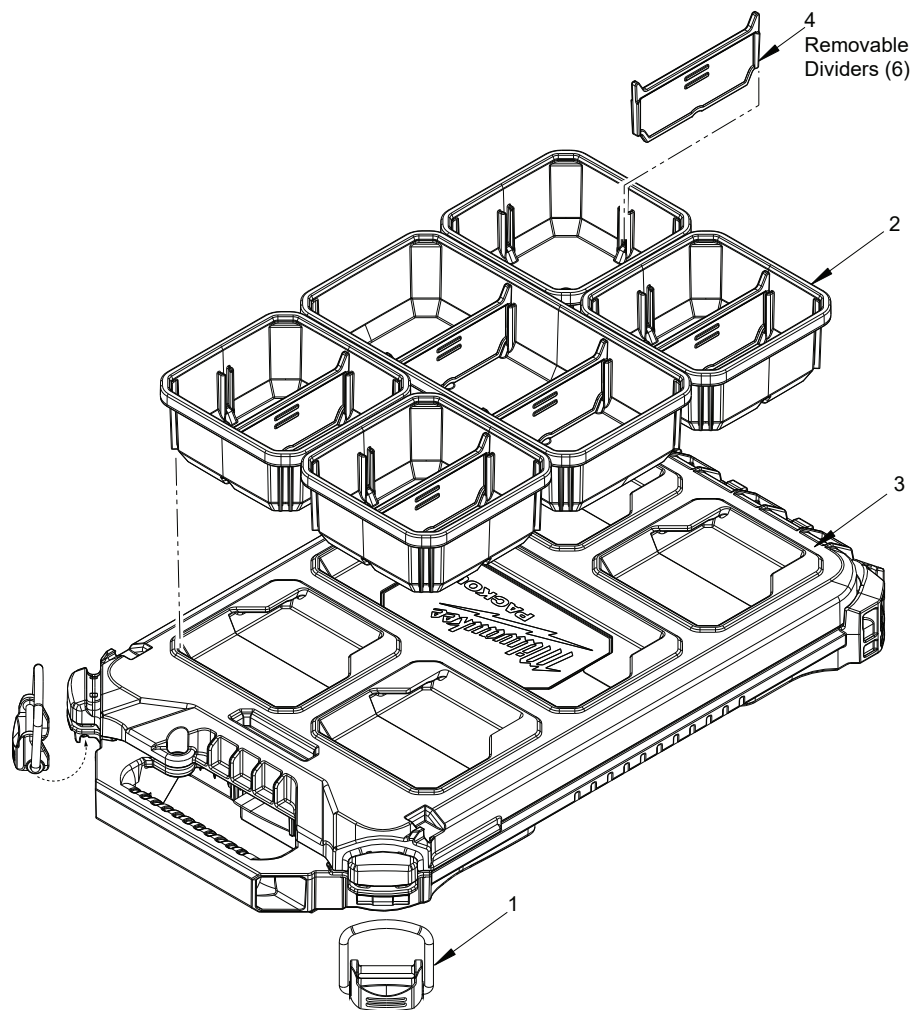

#### 48-22-8436 PACKOUT™ S-Organizer Compact Assembly

FIG.	PART NO.	DESCRIPTION OF PART	NO. REQ.
1	44-20-8436	LP Compact Org Latch (Set of 2)	(1)
2	31-01-0502	5 PC Bin S-Organizer with 6 Dividers	(1)
3	43-44-8435	Lid Gasket (Not Shown)	(1)
4	31-01-0503	Spare Divider Kit, 6 pcs.	(1)

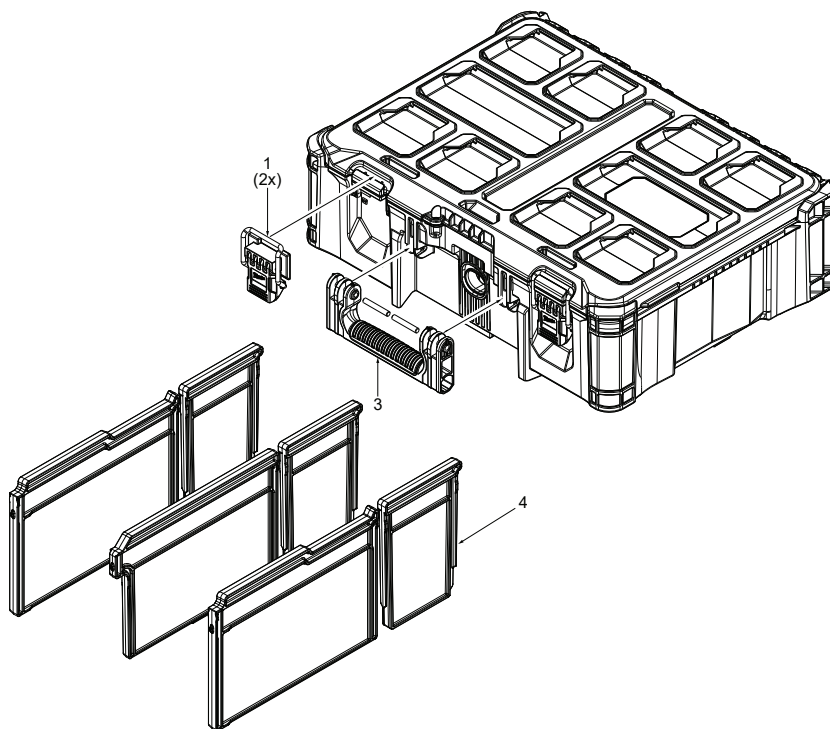

# **48-22-8432 PACKOUT™ Deep Organizer**

FIG.	PART NO.	DESCRIPTION OF PART	NO. REQ.
1	44-20-8430	Service Latch Assembly (Set of 1)	(2)
2	43-44-8430	Lid Service Gasket (Not Shown)	(1)
3	43-62-8430	Service Handle	(1)
4	31-01-8432	Divider Service Kit	(1)

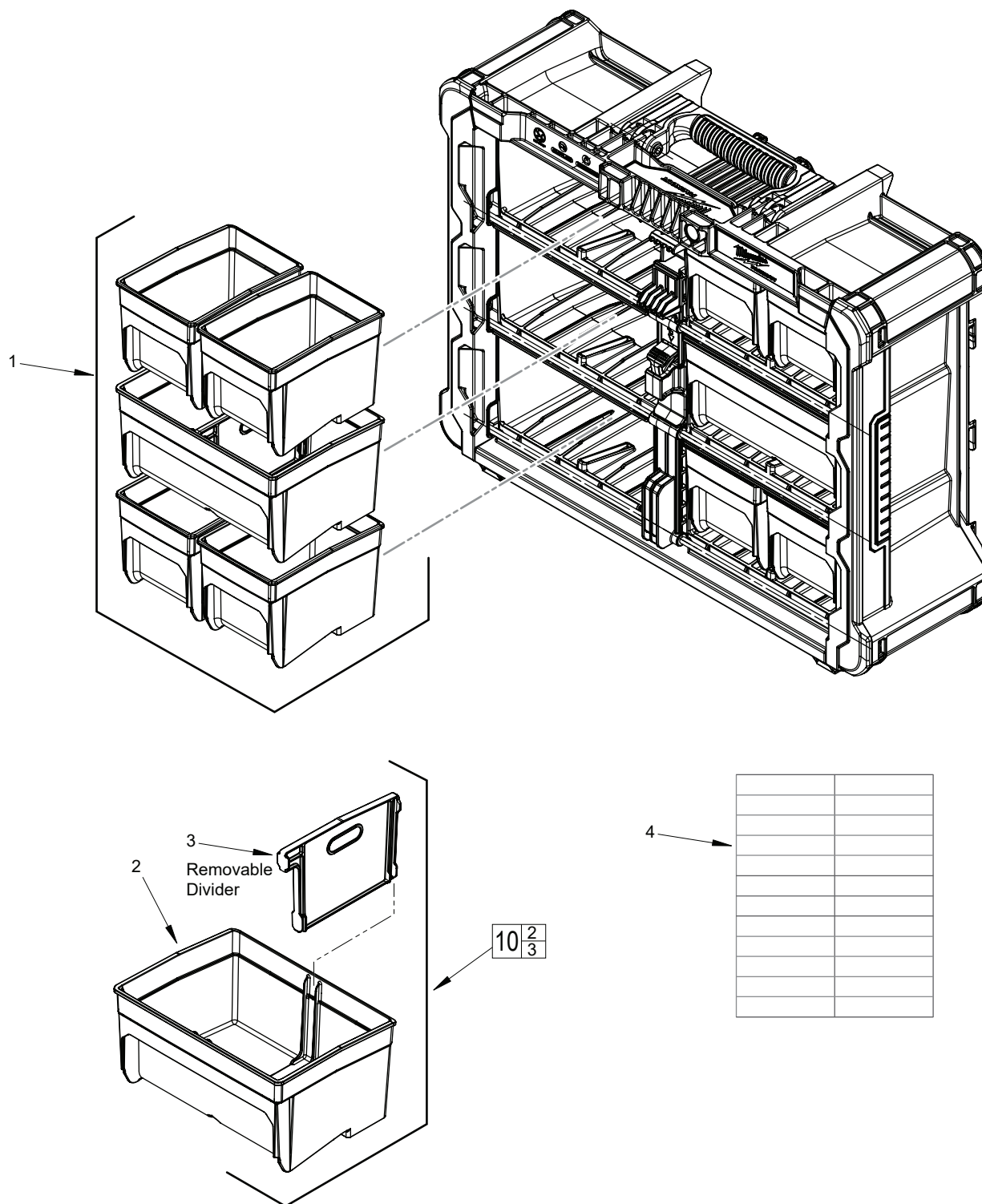

# **48-22-8433 PACKOUT™ Tilt Bin Organizer**

FIG.	PART NO.	DESCRIPTION OF PART	NO. REQ.
1	14-46-8433	5 Tilt Bin Kit with 1 Divider	(2)
2	-----	Tilt Bin, Large	(1)
3	-----	Divider	(1)
4	58-65-8433	Tilt Bin Labels (24 count)	(1)
10	48-22-8434	Tilt Bin, Large, with Divider	(2)