

# WIRING INSTRUCTIONS

TITLE

SAWZALL®

MILWAUKEE ELECTRIC TOOL CORP. 13135 WEST LISBON RD. BROOKFIELD, WIS.

DATE  
Dec. 2011

BULLETIN  
58-01-0056

**NOTE:** For (DI) Double Insulated tools disregard the following:  
Green cord lead '2C', green leadwire assembly 23-94-0025 '3',  
terminals 'T4', 'T5', 'T6' and the grounding pin.

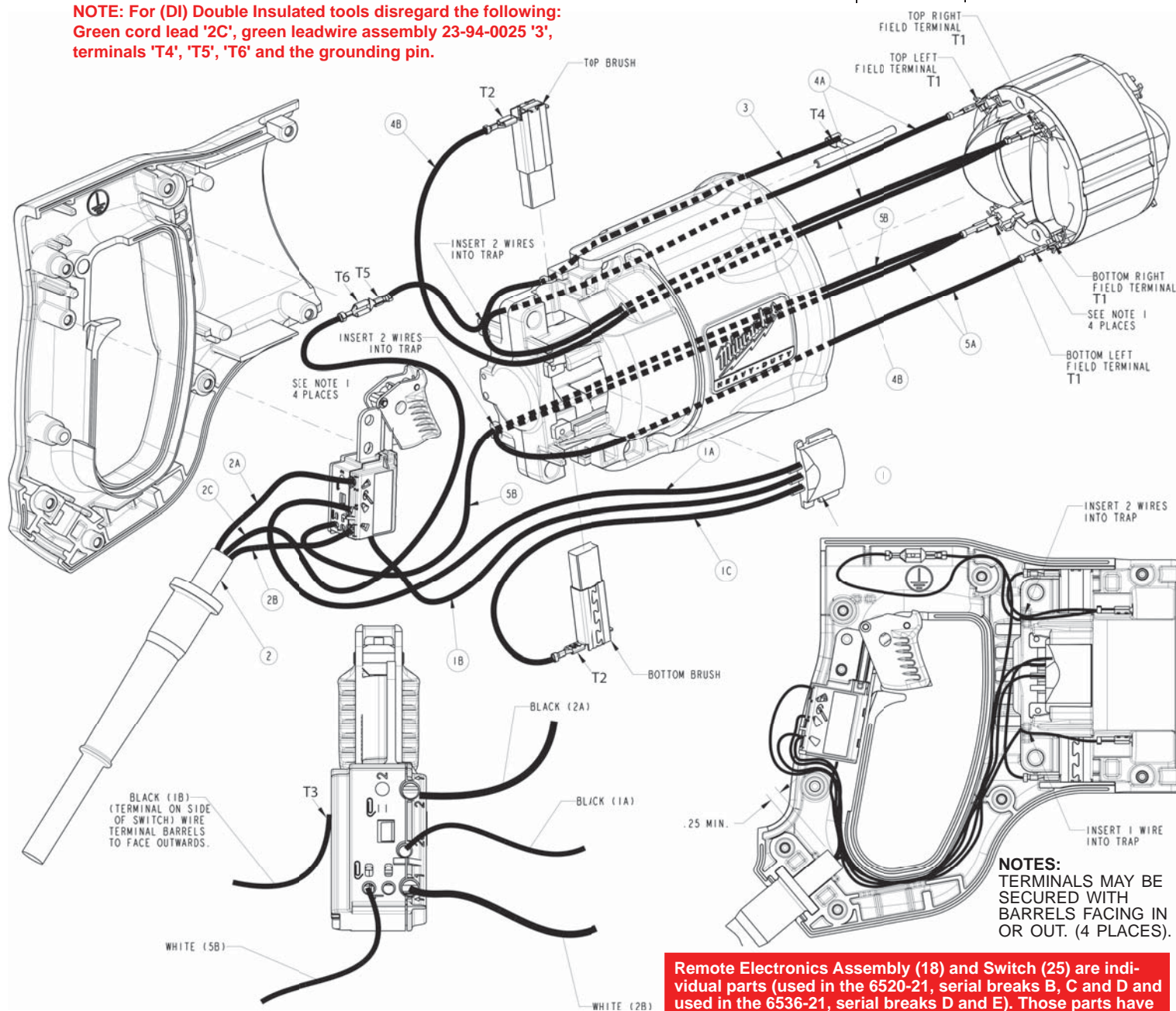

## WIRING SPECIFICATIONS

Wire No.	Wire Color	Origin or Part No.	Ga.	Length	Terminals, Connectors and End Wire Preparation
1A	Black	14-20-3151	18	10.25	Strip .320 and tin.
1B	Black or Yellow	14-20-3151	18	9.5	Strip .19 for T3.
1C	Black or Blue	14-20-3151	18	2.40	Strip .19 for T2.
2A	Black	Cord Assembly	16	4.00	Strip .340 and tin.
2B	White	Cord Assembly	16	3.25	Strip .340 and tin.
2C	Green	Cord Assembly	16	11.25	Strip .19 for T6.
3	Green	23-94-0025	18	7.00	Strip each end .190 for T4 and T5.
4A	White	23-94-6750	18	2.90	Strip one end .19 for T2.
4B	White	23-94-6750	18	5.00	Strip one end .15 for T1.
5A	White	23-94-6755	18	9.25	Strip one .320 and tin.
5B	White	23-94-6755	18	5.00	Strip one end .15 for T1.

BULK LEAD WIRE - BULLETIN 58-01-0003

## NOTE:

All leads must be held to  $\pm 1/8"$ .  
All lead lengths are before stripping.

## TERMINAL DESCRIPTION

Code	Part No.	Qty.
T1	23-74-1060	4
T2	23-74-0017	2
T3	23-74-0010	1
T4	23-74-0605	1
T5	23-74-0105	1
T6	23-74-1095	1

**NOTE:** For (DI) Double Insulated tools disregard the following:  
Green cord lead '2C', green leadwire assembly 23-94-0025 '3',  
terminals 'T4', 'T5', 'T6' and the grounding pin.

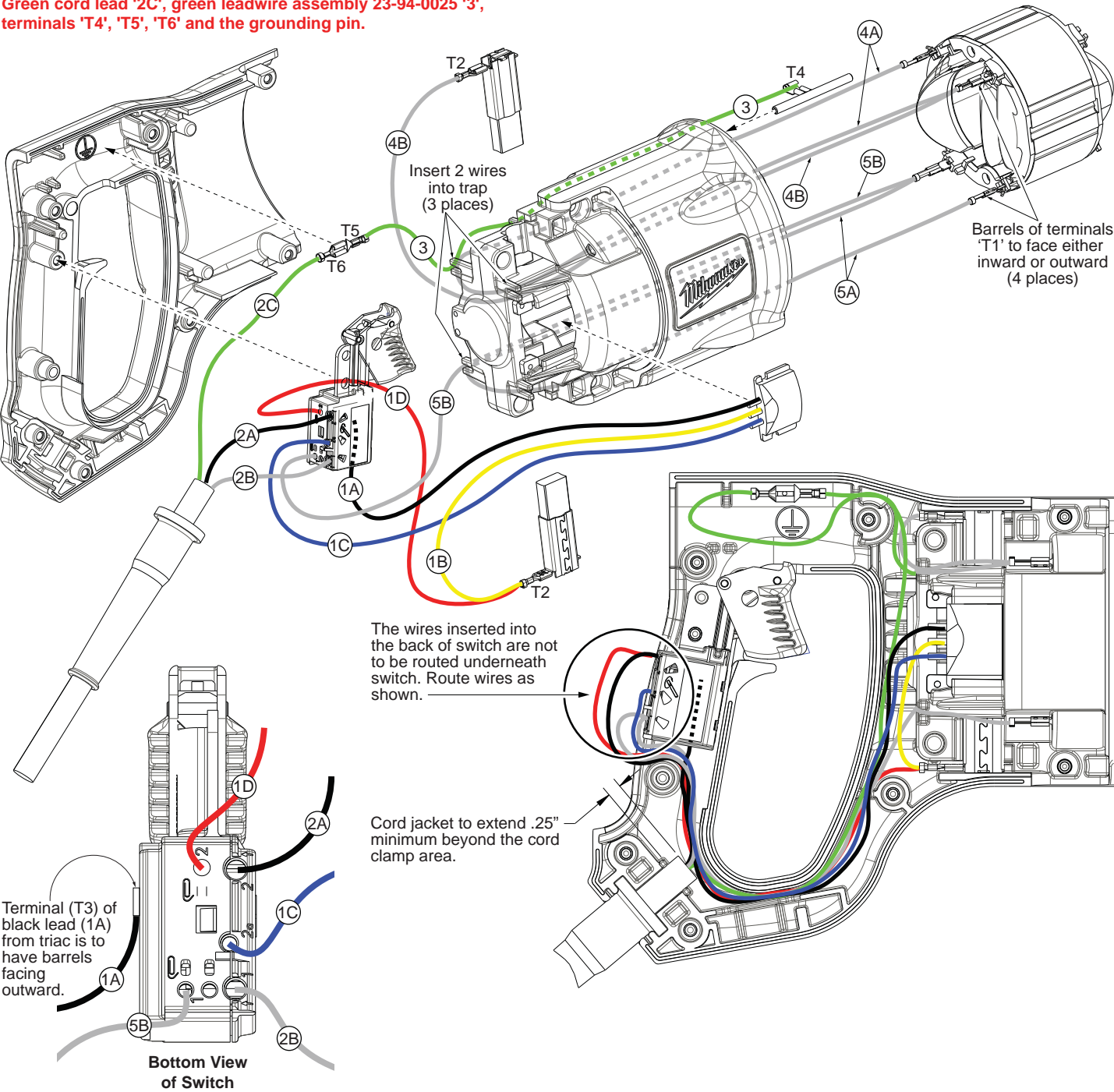

WIRING SPECIFICATIONS					
Wire No.	Wire Color	Origin or Part No.	Ga.	Length	Terminals, Connectors and End Wire Preparation
1A	Black	TRIAC	---	---	Component of Switch Assembly 23-66-4245.
1B	Yellow	TRIAC	---	---	Component of Switch Assembly 23-66-4245.
1C	Blue	TRIAC	---	---	Component of Switch Assembly 23-66-4245.
1D	Red	TRIAC	---	---	Component of Switch Assembly 23-66-4245.
2A	Black	Cord Assembly	16	4.00	Strip .340 and tin.
2B	White	Cord Assembly	16	3.25	Strip .340 and tin.
2C	Green	Cord Assembly	16	11.25	Strip .19 for T6.
3	Green	23-94-0025	18	7.00	Strip each end .190 for T4 and T5.
4A	White	23-94-6750	18	2.90	Strip one end .19 for T2.
4B	White	23-94-6750	18	5.00	Strip one end .15 for T1.
5A	White	23-94-6755	18	9.25	Strip one .320 and tin.
5B	White	23-94-6755	18	5.00	Strip one end .15 for T1.

BULK LEAD WIRE - BULLETIN 58-01-0003

**NOTE:**  
All leads must be held to  $\pm 1/8"$ .  
All lead lengths are before stripping.

TERMINAL DESCRIPTION		
Code	Part No.	Qty.
T1	23-74-1060	4
T2	23-74-0017	2
T3	23-74-0010	1
T4	23-74-0605	1
T5	23-74-0105	1
T6	23-74-1095	1