

WIRING INSTRUCTIONS

TITLE	PANEL SAW MOTOR	BULLETIN
MILWAUKEE ELECTRIC TOOL CORP. 13135 WEST LISBON RD. BROOKFIELD, WIS.	DATE Dec. 2001	58-01-0765

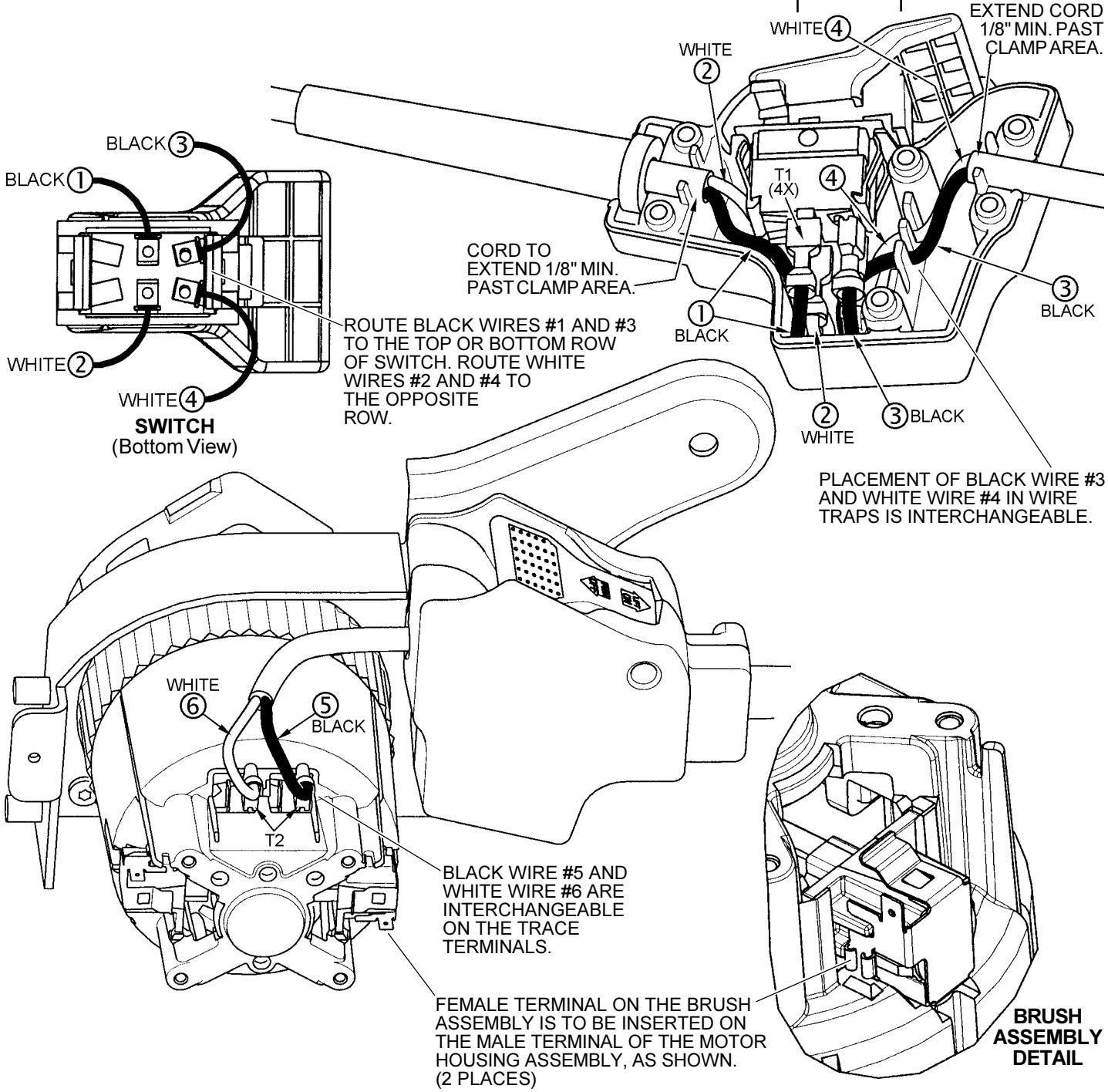

WIRING SPECIFICATIONS				
Wire No.	Wire Color	Origin or Gauge	Length	Terminals, Connectors and 1 or 2 End Wire Preparation
1	Black	14 GA.	4.00"	Comp. of cord assy. 22-64-0255. Strip 3/16" for T1.
2	White	14 GA.	4.00"	Comp. of cord assy. 22-64-0255. Strip 3/16" for T1.
3	Black	14 GA.	4.50"	Comp. of lead assy. 23-94-0090. Strip 3/16" for T1.
4	White	14 GA.	4.50"	Comp. of lead assy. 23-94-0090. Strip 3/16" for T1.
5	Black	14 GA.	2.00"	Comp. of lead assy. 23-94-0090. Strip 3/16" for T2.
6	White	14 GA.	2.00"	Comp. of lead assy. 23-94-0090. Strip 3/16" for T2.

NOTE:
 All leads must be held to ± 1/8".
 All lead lengths are before stripping.

TERMINAL DESCRIPTION		
Code	Part No.	Qty.
T1	23-74-0970	4
T2	23-74-0280	2