

WIRING INSTRUCTIONS

TITLE

BODY GRIP JIG SAW

MILWAUKEE ELECTRIC TOOL CORP. 13135 WEST LISBON RD. BROOKFIELD, WIS.

DATE
Aug. 2002

**BULLETIN
58-01-1171**

As an aid to reassembly, take note of wire routing and position in wire guides and traps while dismantling tool.

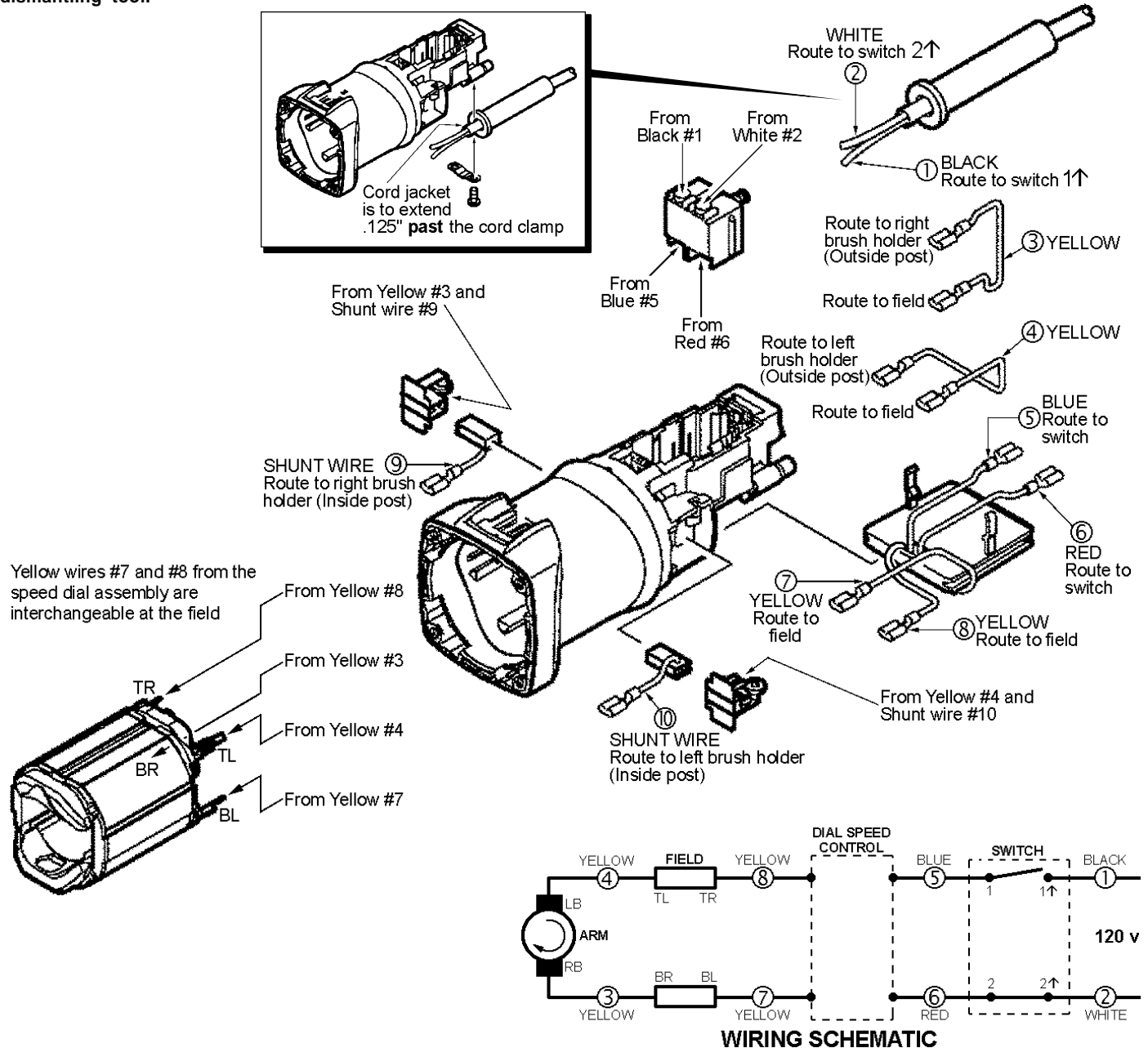

WIRING SPECIFICATIONS

Wire No.	Wire Color	Origin or Gauge	Length	Terminals, Connectors and 1 or 2 End Wire Preparation
1	Black	Cord	-----	Component of Cord Set.
2	White	Cord	-----	Component of Cord Set.
3	Yellow	23-94-6640	-----	Leadwire Assembly.
4	Yellow	23-94-6640	-----	Leadwire Assembly.
5	Blue	Dial Assy.	-----	Component of the Speed Dial Assembly.
6	Red	Dial Assy.	-----	Component of the Speed Dial Assembly.
7	Yellow	Dial Assy.	-----	Component of the Speed Dial Assembly.
8	Yellow	Dial Assy.	-----	Component of the Speed Dial Assembly.

BULK LEAD WIRE - BULLETIN NO. 58-01-0003

NOTE:

All leads must be held to $\pm .125"$.
All lead lengths are before stripping.

TERMINAL DESCRIPTION

Code	Part No.	Qty.

CONNECTOR DESCRIPTION
