



# SERVICE PARTS LIST

**BULLETIN NO.**  
PN0014130

SPECIFY CATALOG NO. AND SERIAL NO. WHEN ORDERING PARTS		REVISED BULLETIN	DATE
<b>Rechargeable Pivoting Task Light</b>			Dec. 2025
<b>CATALOG NO.</b> 2015R	<b>SERIAL NO.</b> S02A	WIRING INSTRUCTION	
<b>NAMEPLATE SPECIFICATIONS:</b> 5 V = 3 A Contains 12 Wh Li-Ion			

**EXAMPLE:**  

00	0
----	---

 Component Parts (Small #)  
 Are Included When Ordering  
 The Assembly (Large #).

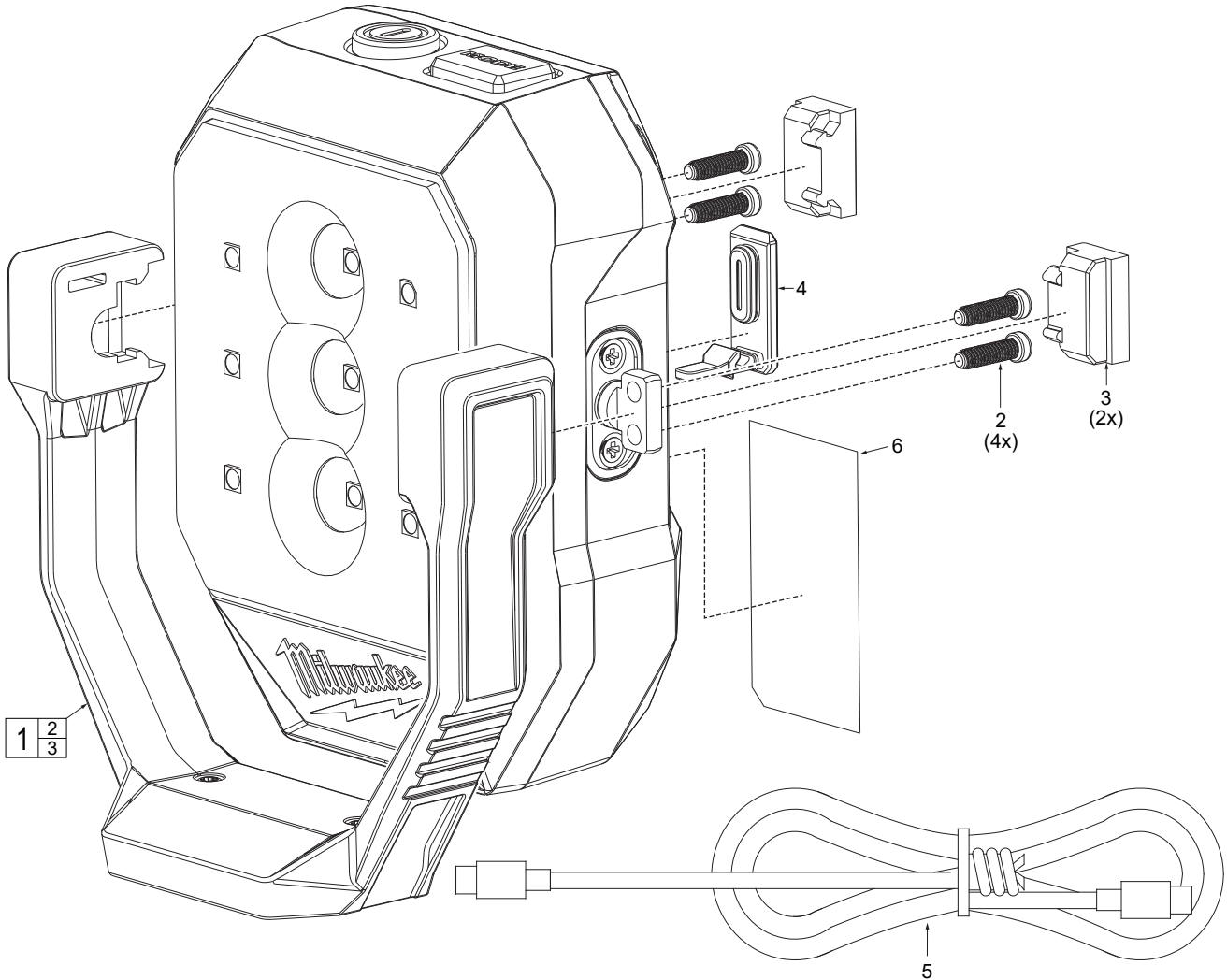

FIG.	PART NO.	DESCRIPTION OF PART	NO. REQ.
1	44-04-2015	Leg Assembly	(1)
2	23-44-0259	M2.5 x 9mm PT Steel Screw	(4)
3	22-68-1107	Screw Cover	(2)
4	22-68-2015	USB Cover	(1)
5	42-44-1211	USB-C to USB-C Cable (Optional)	(1)
6	12-20-2015	Service Nameplate	(1)

**FIG. 6 NOTES**  
 A clean, dry surface is essential for proper performance for any adhesive system. The area intended for application of any adhesive label or nameplate must be prepared by cleaning with isopropyl alcohol. The solvent is to be applied with a clean, lint free applicator and the surface allowed to dry before applying the label or nameplate.