



TO INFORM YOU

PRODUCT  
SUPPORT  
BULLETIN # 426

TO: AUTHORIZED *portable electric tool* SERVICE STATIONS  
*factory* SERVICE / SALES SUPPORT BRANCH  
SALES COMPANIES - Customer Centers

DATE: October 2004

TOOL(S) \ PRODUCT(S) AFFECTED: 1680-20 1/2" Super-Hawg® Drill

**SUBJECT: loosening of gearcase front handle screws**

**05-88-9915 M5 X 25mm Torx T25 Pan Head Screw**

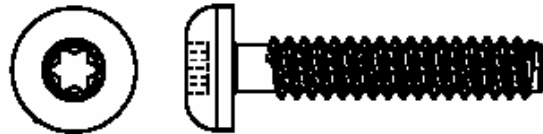
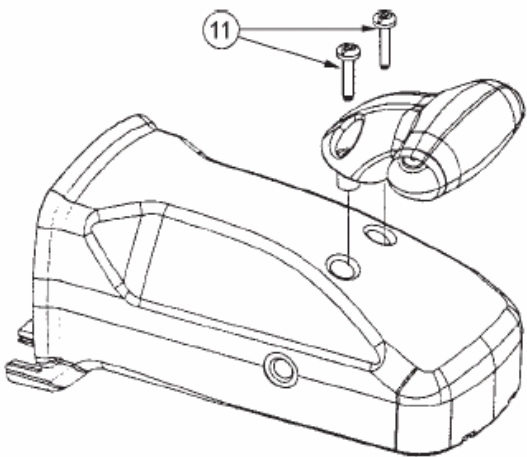

Current production 1680-20 1/2" Super-Hawg® Drills have incorporated a change to the gearcase front handle screws.

**05-88-9915 M5 X 25mm T25 Pan Head Screw** [fig 11], offering higher break away torque to stop the screw from backing-out and coming loose, replaces the original 05-88-9910 Slotted Torx [T25] M5 Pan Head Front Handle Screw.

**05-88-9915 M5 X 25mm T25 Pan Head Screw** is a **thread forming screw** which will work in a 28-14-2546 Gear Case Assembly with existing thread formed screw holes from the 05-88-9910 screw, providing a higher back-out / break away torque to prevent the screw from coming loose. Two [2] 05-88-9915 Torx M5 Pan Head Screws should be substituted / installed when repairing the Super-Hawg® Drills.

**Note! 05-88-9915 M5 X 25mm T25 Pan Head Screw** calls for double the seating torque – **55-65 in/lbs** (6-7 Nm) – that was required by the 05-88-9910 screw and should be seated and checked using a torque wrench.

**05-88-9910** Slotted Torx [T25] M5 Pan Head Screw is used in other product and will remain a saleable service replacement part.

This bulletin is for informational purposes. PLEASE NOTE ON SERVICE PARTS LIST: 54-10-0250