



TO INFORM YOU

**PRODUCT
SUPPORT
BULLETIN # 429**

TO: AUTHORIZED *portable electric tool* SERVICE STATIONS
factory SERVICE / SALES SUPPORT BRANCH
SALES COMPANIES

DATE: February 2005

TOOL(S) \ PRODUCT(S) AFFECTED: 6509-20, 6509-22 Sawzall®, 6519-22 Sawzall Plus®

SUBJECT: 14-67-0135 (Primary) Wobble Plate Assembly

List Price \$22.25 USD

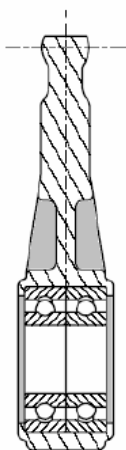
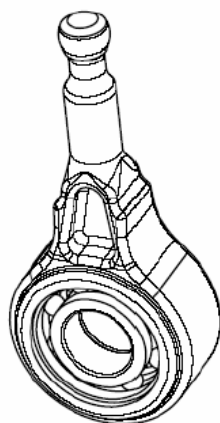

14-67-0135 Wobble Plate Assembly is a new service replacement part for the primary wobble plate used in the 6509-20, 6509-22 Sawzall®, 6519-22 Sawzall Plus®.

14-67-0135 Wobble Plate Assembly features a lip which is formed over the two [2] 02-04-1510 Ball Bearings to trap (hold) them in place, eliminating the internal retaining ring (34-80-2600). The 02-04-1510 ball bearings are not able to be removed and replaced; if there should be a failure (wear-out) of the ball bearings or ball-end stud of the wobble plate, a complete new 14-67-0135 Wobble Plate Assembly must be used.

30-72-0085 Wobble Plate status will remain unchanged for the present as it has other usage – Super & Orbital Super Sawzalls®.

This bulletin is for informational purposes. PLEASE NOTE ON SERVICE PARTS LIST: 54-40-5180, 54-40-5210