



TO INFORM YOU

PRODUCT  
SUPPORT  
BULLETIN # 440

TO: AUTHORIZED *Portable Electric Tool* SERVICE STATIONS  
*factory* SERVICE / SALES SUPPORT BRANCH CENTERS  
SALES COMPANIES

DATE: June 2005

TOOL(S) \ PRODUCT(S) AFFECTED : 5359 21, 5360-21 SDS 1-1/8" Rotary Hammer

**SUBJECT:** pressing of Intermediate Gear Set onto Armature pinion shaft... binding / screaming / very noisy

**SERVICE NOTE!** Intermediate Gear of Intermediate Gear Set [fig. 420] presses down flush to the top of the armature pinion against Spacer [fig. 414], Sleeve [fig 413] and Ball Bearing [fig. 409]. If the tool is binding / screaming / very noisy the problem could be the spacing / position of the ball bearing [fig 409] in the assembly. The armature pinion shaft does not have a shoulder or retainer for the ball bearing to stop against. Remove **ONLY** Intermediate Gear Set assembly [fig. 420] from armature - leaving Insulating Disc [fig. 410] in place and repress the ball bearing, spacer, sleeve and bevel gear onto the armature shaft **ALL** at the same time; allowing the ball bearing to **self-space / self-position** itself on the pinion shaft.

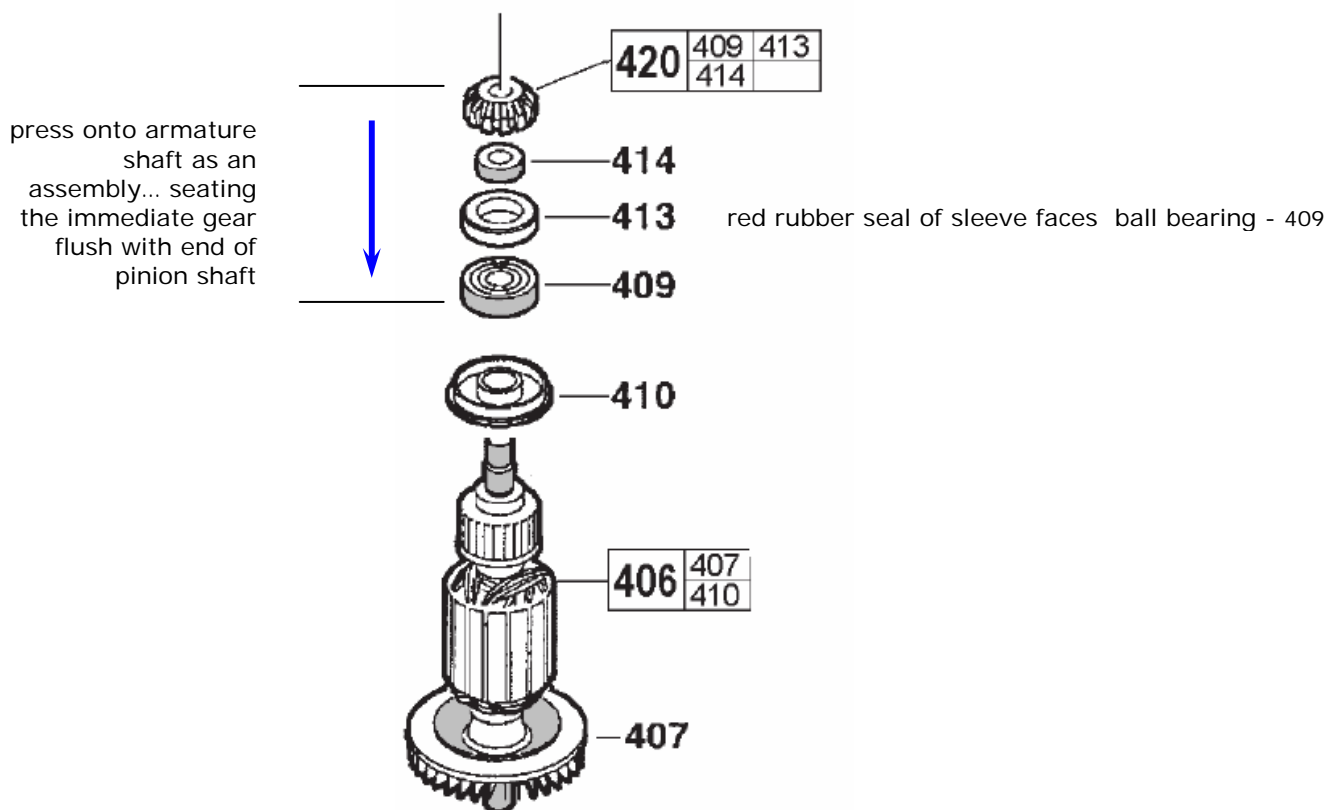

This bulletin is for informational purposes. PLEASE NOTE ON SERVICE PARTS LIST: 54-24-5000, 54-24-5025