



TO INFORM YOU

**PRODUCT
SUPPORT
BULLETIN # 448**

TO: AUTHORIZED *Portable Electric Tool* SERVICE STATIONS
factory SERVICE / SALES SUPPORT BRANCH CENTERS

DATE: April 2006

TOOL(S) \ PRODUCT(S) AFFECTED: 6523-21, 6536-21, 6523-51, 6523-55, 6536-51 13Amp Orbital
Super Sawzall

SUBJECT: removal / installation of the two [2] long Dowel Pins 06-65-0045 (fig 7) in Front & Rear
Spindle Bushing / Counter Weight - Spindle Assembly Mechanism

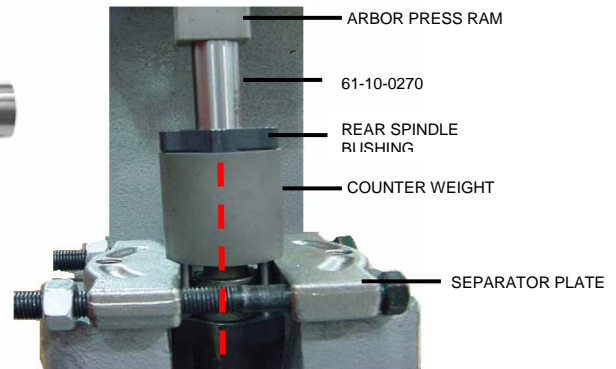
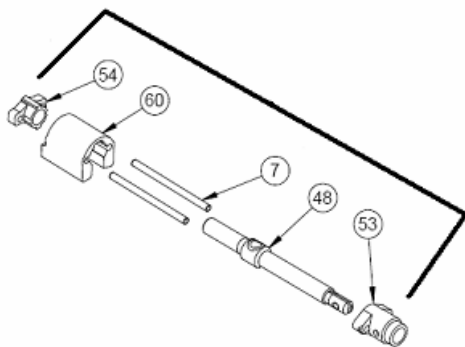

Disassembling Spindle Assembly Mechanism

1. to disassemble the **spindle assembly** (figs 54, 60, 7, 48, 53) place a bearing separator plate around dowel pins with flat side of separator plates contacting the flats of counter weight (fig 60) - place **61-10-0270 Spindle Press Pin** through the rear spindle bushing, contacting the rear of the spindle - using an arbor press; press the spindle assembly through rear bushing and counter-weight, pressing the dowel pins out of the rear bushing and freeing the front spindle bushing and spindle assembly.
2. use a small punch to drive the two dowel pins from the front spindle bushing, only if its replacement is necessary - if the counter weight is the only thing that needs to be replaced we would recommend not removing the dowel pins from the front spindle bushing - just press the rear spindle bushing off the pins using the service fixture.

Assembling Spindle Assembly Mechanism

1. press the two dowel pins into the new front and rear spindle bushings until they are flush with the top opening in the bushing
2. once you press the assembly back together the spindle must move back and forth freely between the front and rear spindle bushings, parallelism of the two dowels is critical - if the assembly is tight, one of the dowel pins will be misaligned with the other, should this occur tap - re-align whichever pin is slightly misaligned

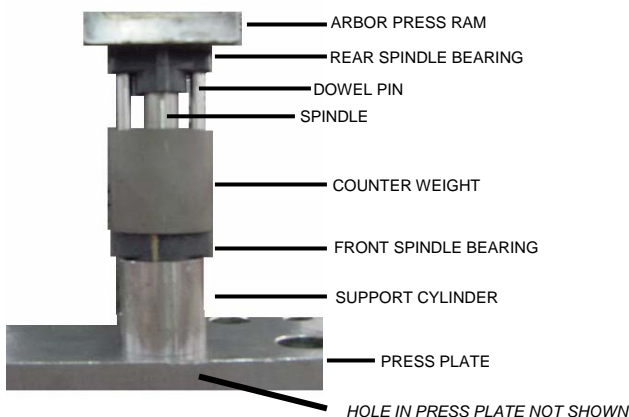

check to make sure dowel pins are flush
with front spindle bushing bore face as
pictured - bore extends past face - pins
should not protrude past face

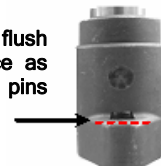

dowel pins flush with rear
spindle bushing

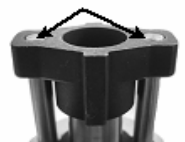

This bulletin is for informational purposes. PLEASE NOTE ON SERVICE PARTS LIST: 54-40-7560, 54-40-7561, 54-40-7580, 54-40-7581, 55-40-7560, 55-40-7580, 55-40-7600 Additional information on assembling the mechanism see PSB #447.