



TO INFORM YOU

**PRODUCT
SUPPORT
BULLETIN # 454**

TO: AUTHORIZED *portable electric tool* SERVICE STATION
factory SERVICE / SALES SUPPORT BRANCH

DATE: May 2006

TOOL(S) \ PRODUCT(S) AFFECTED: Serial No. Prefix A & B - 5311, 5316, 5316-4 1-1/2" Thunderbolt Rotary Hammer and 5334, 5334-51 Light Chipping Hammer

SUBJECT: substituting a 28-14-2285 or 28-14-2295 Crankcase Assembly for obsolete 28-14-2255 and 28-14-2265 Crankcase Assembly

Crankcase Assembly 28-14-2255 and 28-14-2265 used in serial prefix A & B of the above listed tools are obsolete.

When servicing a Rotary Hammer / Light Chipping Hammer within the revision code / serial prefix A or B and a 28-14-2255 or 28-14-2265 crankcase is needed, crankcase assembly 28-14-2285 or 28-14-2295 can be substituted by performing a minor modification to the original left and right crankcase shrouds using a 7/8" flat boring bit to drill the shroud out to accommodate the two rear side handle studs on the new crankcase

Place the sharp tip of a 7/8" flat boring bit into the center of the recessed area located on the backside of the existing left and right shroud and drill openings in the shrouds.

If either of the original left (31-55-0200) or right (31-55-0210) crankcase shrouds are damaged and can no longer be used, a new 31-55-0240 left shroud or new 31-55-0250 right shroud can be substituted.

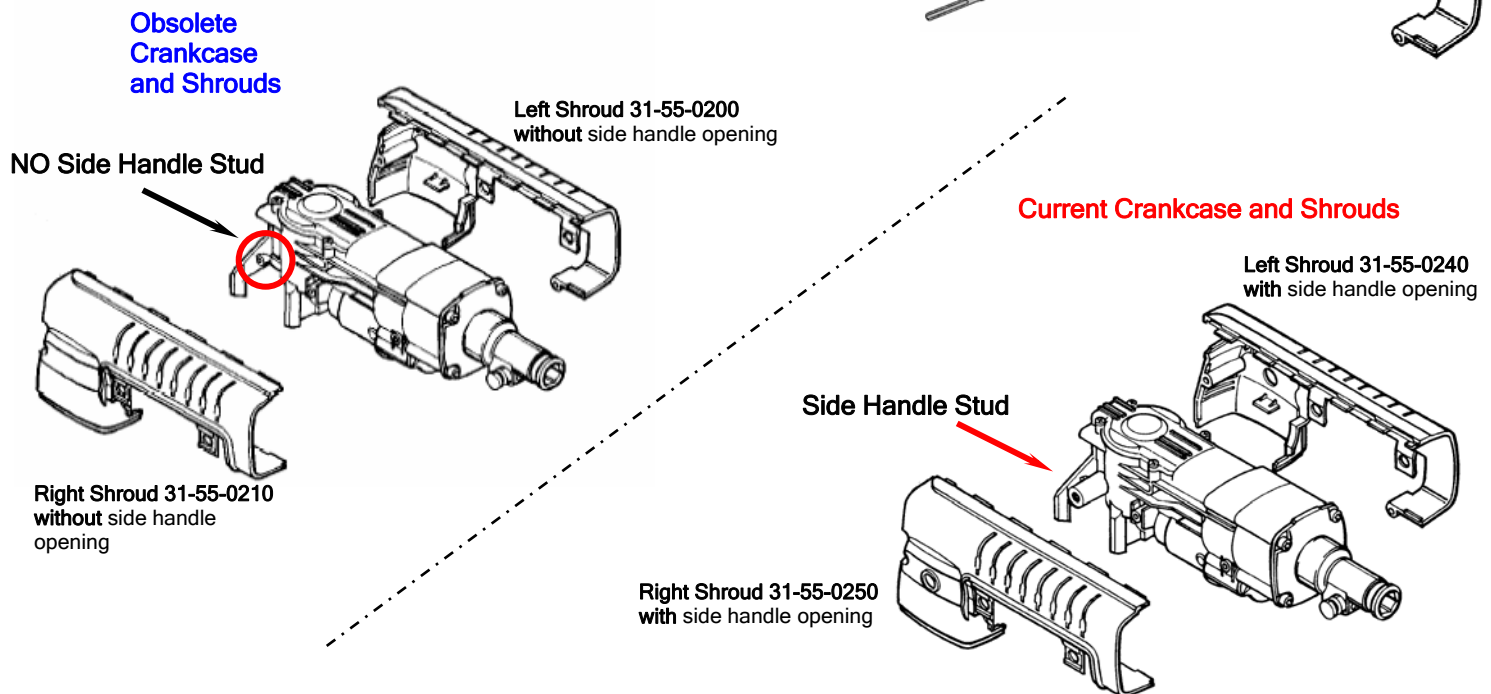

Use Crankcase **28-14-2295** when servicing a Rotary Hammers 5316 and 5316-4

Use Crankcase **28-14-2285** when servicing a Rotary Hammer 5311 and Chipping Hammer 5334, 5334-51

This bulletin is for informational purposes. PLEASE NOTE ON SERVICE PARTS LIST: 54-24-0400, 54-24-0401, 54-24-0425, 54-24-0426, 54-24-0475, 54-24-0476, 55-24-0425, 55-24-0426, 55-24-0475