



TO INFORM YOU

**PRODUCT
SUPPORT
BULLETIN # 459**

TO: AUTHORIZED *Portable Electric Tool* SERVICE STATIONS
factory SERVICE / SALES SUPPORT BRANCH CENTERS

DATE: November 2006

TOOL(S) \ PRODUCT(S) AFFECTED: 5359-21 1-1/8" SDS Rotary Hammer

SUBJECT: Spindle difference between revision 'A' & 'B' - 38-50-0011 Spindle / Spindle Gear Kit

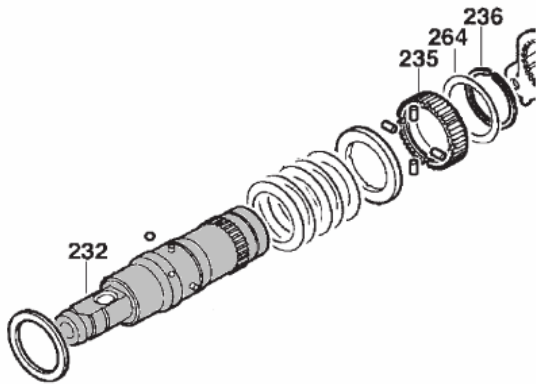

Revision 'A' 38-50-0038 Spindle - Spindle Gear 22-75-1207 (fig. 235) contains a recess for flat Washer 45-88-1181 (fig. 264) and a **FLAT Retaining Ring** 44-90-4510 (fig. 236) is used to secure spindle gear to the spindle. Note: original equipment 38-50-0038 Spindle is replaced by a **38-50-0011 Spindle Kit**, which updates to revision 'B' Spindle / Spindle Gear.

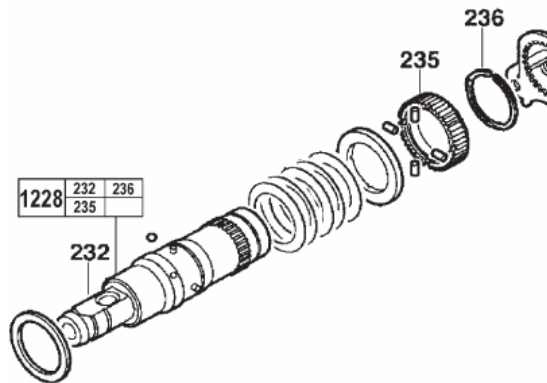

Revision 'B' 38-50-0058 Spindle - **no recess** in Spindle Gear 32-10-0055 and **no washer** is being used; (fig 236) is a **ROUND Retaining Ring** 40-50-8492

This bulletin is for informational purposes. PLEASE NOTE ON SERVICE PARTS LIST: 54-24-5000, 54-24-5001