



TO INFORM YOU

**PRODUCT
SUPPORT
BULLETIN # 371**

TO: AUTHORIZED *Portable Electric Tool* SERVICE STATIONS
factory SERVICE CENTERS
SALES COMPANIES

DATE: July, 2001

FROM: Corbert A. Garb - National Service Manager

TOOL(S) \ PRODUCT(S) AFFECTED

9070-20, 9071-20, 9075-20 Impact Wrench

SUBJECT: 31-17-0270 Cord Clamp Replacement Instructions -

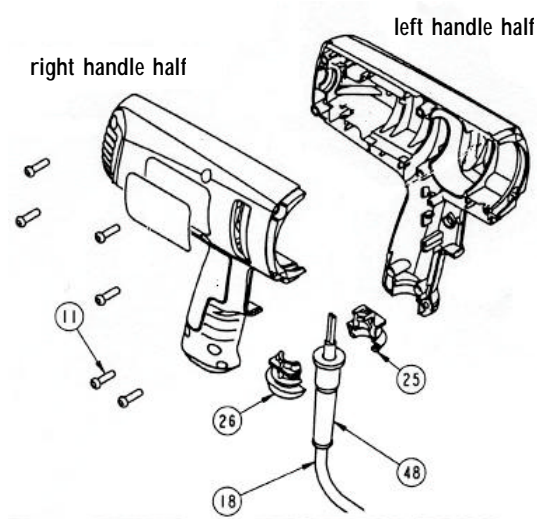

1. Separate handle halves by removing six [6] T-20 Torx head screws [fig 11] from the right handle half.

2. **Note! Only** remove the two [2] T-20 Torx head Front Housing / Gearcase screws [fig 10] on the right side. Loosen the two [2] left side screws a maximum of 1/4", leaving them in position to hold the Front Housing / Gearcase in place.

3. Pry the Front Housing / Gearcase forward 1/4" maximum, allowing for the right handle half to be removed.

4. Make note of wire routing [see *Wiring Instructions 58-01-1820*].

5. Remove original equipment cord clamp [fig 26] found in the **right handle half** replacing it with a 31-17-0270 Cord Clamp. 31-17-0270 Cord Clamp has the numbers '0270' molded into it's clamping rib.

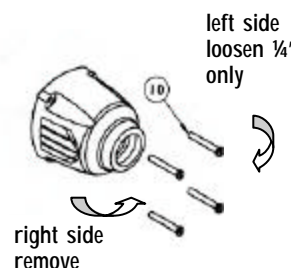

6. Reposition the cord protector [fig 48] & cord body [fig 18] in the left handle half increasing the length of cord inserted through the cord protector [strain relief], cord clamp and into the cavity of the handle from .25" beyond top of cord clamp to **1.25"**. **Note:** cord clamp assembly of the Impact Wrench is a two piece design, consisting of a 31-17-0260 Cord Clamp with posts [see *illustration*] assembled in the Left Handle Half and the 31-17-0270 Cord Clamp assembled in the Right Handle Half. [Check for proper repair, tugging on the cord after assembly will insure the cord clamp assembly is correct and that the cord set does not easily pull through the clamp.]



31-17-0260 Cord Clamp w/ posts

7. Reposition right handle half and verify wire routing, being careful not to pinch any wires [see *Wiring Instructions*].
8. Re-install Front Housing / Gearcase.
9. Tighten six [6] T-20 Handle and four [4] T-20 Front Housing screws until they are 'vigorously hand-tight'.

tighten bottom screw first [1], then top [2], then two rear screws and lower handle / cord clamp screws



Please see To Inform You/ Product Support Bulletin #358, 370.

This bulletin is for informational purposes. PLEASE NOTE ON SERVICE PARTS LIST; 54-26-1700, -1725, -1775